

FIRE RATING

FD60

halo
assist

Installation supportline:

call 020 3880 0339

selo

Concealed Frame Doorsets
Riser Doors & AOVs

Una
Riser door systems



1

2

[Installation instructions](#)

Thank you for choosing Una

To ensure the installation process is simple and efficient we recommended you read this guide in full before you begin.

Tools required

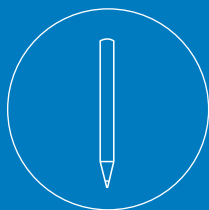

Pencil

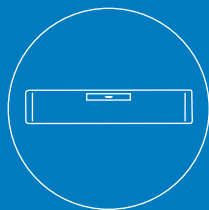

Spirit level

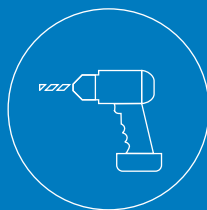

Cordless screwdriver

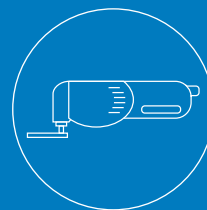

Multitool



Tape measure

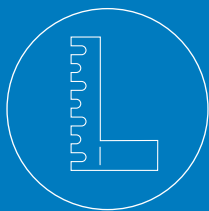

Set square



Knife

IMPORTANT - Fire rating notice

The fire rating of any doorset is subject to a number of factors, including:



1. The design/workmanship of other work, in particular the partitions into which the doorset is fixed.)
2. The doorset being installed in accordance with the installation instructions.

The Una system can be fitted to either studwork or masonry walls, you will need to ensure the wall itself meets the correct fire resistance performance. To comply with the fire certification all four sides of the structural opening need to be lined with plasterboard for the FD30 application.

Please consult Selo for advice and guidance to ensure the fire performance is met.

tel 020 3880 0339 **email** sales@selo-uk.com

Getting started

Before installation, please ensure the system specifications correspond with your project schedule.

Preparing for installation

Your delivery will include one or both of the boxes shown depending on your order.

Ensure you have everything you need prior to installation. Sizes should be checked on the frame box.



Frame box



Door leaf

What's included

Identify the components below and ensure you have everything prior to installation.

Frame Kit



1 Hinge jamb and corresponding reveal



2 Strike jamb and corresponding reveal

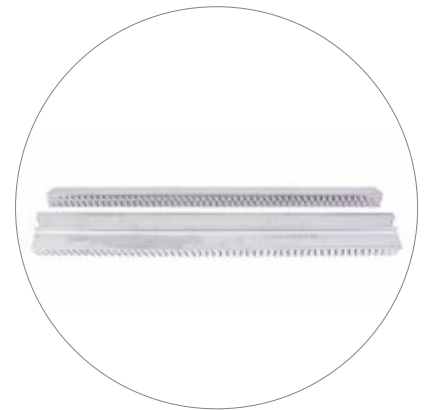

3 Head jamb and corresponding reveal



4 Base jamb and corresponding reveal



5 Black plastic head clips



6 Strike plate with plastic insert and fixings



7 Door

Hinge types

Identify your hinge type and ensure all parts are present

FD60 Una hinge options



1 Butt hinge

A) Step-by-step installation

Before installation please ensure you have carried out the recommendations in the 'Wall Construction Preparation' booklet.

1

Check opening

Ensure that the opening is square and level and the opening dimensions are correct.



2

Hinge jamb

Ensure the black plastic clip is slotted into the top of the hinge jamb with the slot facing away from the perforated edge.



3

Hinge jamb installation



Take the hinge jamb and corresponding reveal and clip together over the wall. Using a level make sure the hinge jamb is plumb and fix into position using x4 drywall screws along the length of the jamb through the perforated flanges.

IMPORTANT

Before installation is complete, further screws will be required. This is covered in Step 9. Do not completely secure frame yet.

4

Head jamb installation

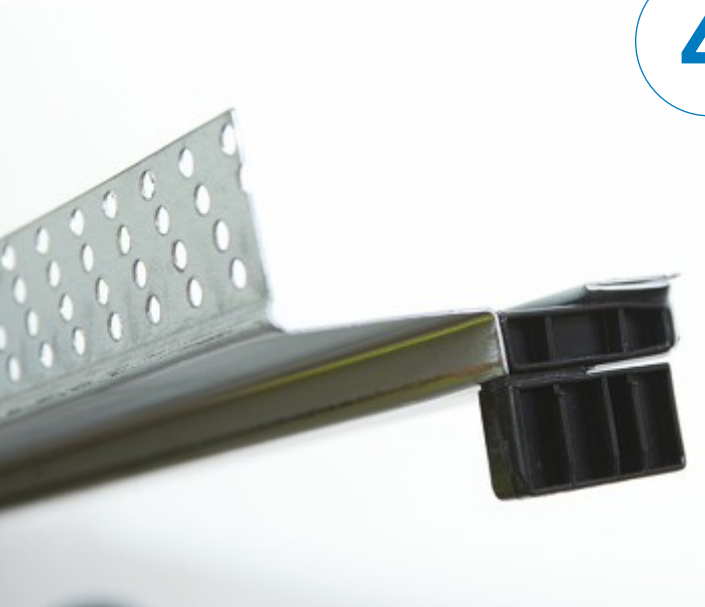

Remove the second black clip from the top of the latch jamb and fit into the latch side of the head jamb.

5

Head jamb preparation



Now slot the opposite end of the head into the black clip at the top of the already installed hinge jamb. The side jamb protrudes 2mm higher than the head jamb. Clip its associated reveal into place and once level secure with x2 screws either side.

IMPORTANT

Before installation is complete, further screws will be required. This is covered in Step 9. Do not completely secure frame yet.

6

Latch jamb installation



Now slot the strike jamb over the black clip located into the head in Step 4.

Before fixing the jamb in position, mark out and mortise the latch stud to accommodate the plastic latch plate insert.



6.1 Mark



6.2 Cut out

Latch plate preparation

6.1 Mark around the latch plate cut-out onto the stud

6.2 Using a multi tool or suitable tool and cut out the section of partition

7

Install latch jamb



Now the latch mortise has been made, install the strike jamb and corresponding reveal in the same manner as the head and hinge jamb.

Ensure the frame is plumb and square. A framing square may be useful at this stage.

7a

Ensure correct installation

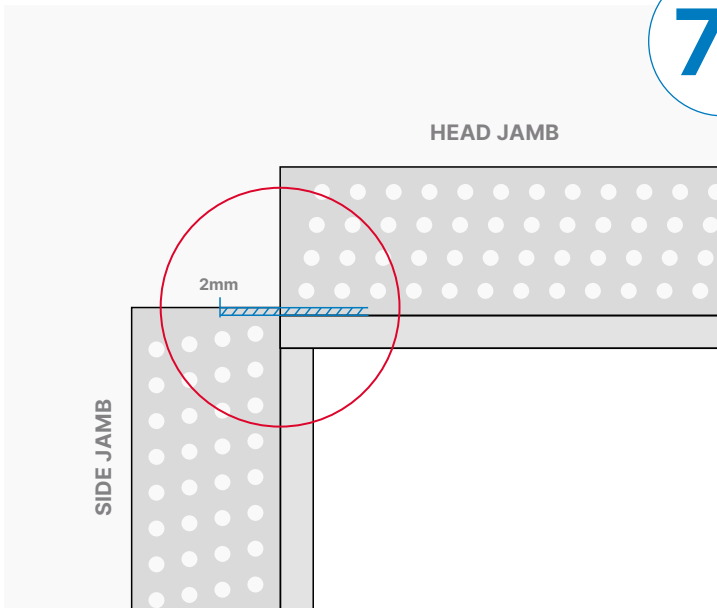

Ensure the head jamb sits inside the two side jambs - 2mm down from the top.

IMPORTANT

This is critical to ensure that the frame is does not distort.

8

Base jamb installation



If the frame being installed is 4 sided, the threshold jamb will need to be installed also.

The bottom of the side jambs will be notched and black plastic clip inserted as shown.

9

Base jamb installation



Insert first one end into the corner clip and then the other and clip the corresponding reveal into place. Ensure it is sitting square and fix into place using 2-3 screws either side.

10

Level-up

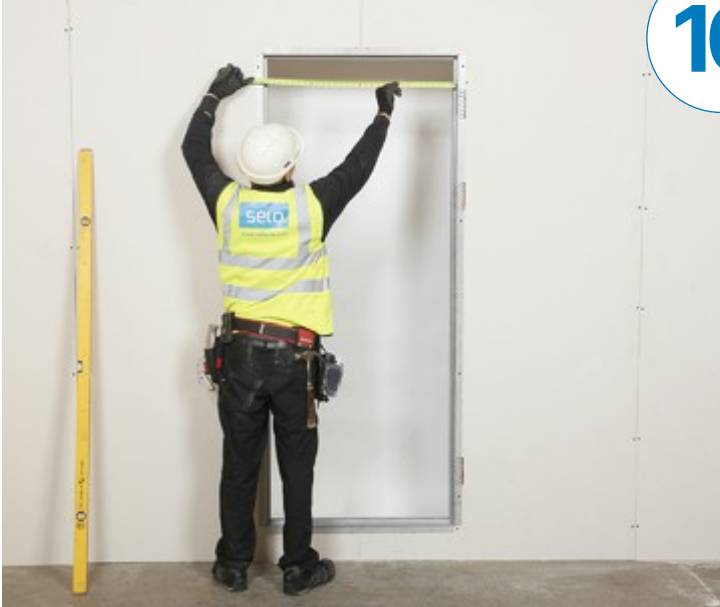

Now ensure the frame is fully level, plumb and square.

11

Fix every 200mm and double screw



11.1 Check the perforated side flanges sit flat against the plasterboard and screw at **200mm increments** around the frame through the flange into the studwork. **Double screw** all the ends of the frame as shown.

11.2 A **double screw** is required above and below the hinge, fixed through the perforated flange as shown. **This applies to all hinge types.**

12

Fix through frame



Once fixings through the perforated flange are complete, fix through the door stop using the holes provided. **Each hole must be used.**

IMPORTANT

DO NOT use expanding foam to install the doorset unless approved by Selo.

13

Plaster tape



Apply plaster fibre tape to the top corners at 45 degrees.

14

Hang door leaf



The door and hinges must be fitted before the reveal is fitted and plastered.

If the door is fire rated then the intumescent strips provided will need to be fitted to the groove in the door edge.

See hinge installation instructions for detailed door leaf instructions. Make sure the hinges and packers are installed prior to adding the reveal section and applying the final fixings to the frame.

15

Plastering / Decoration

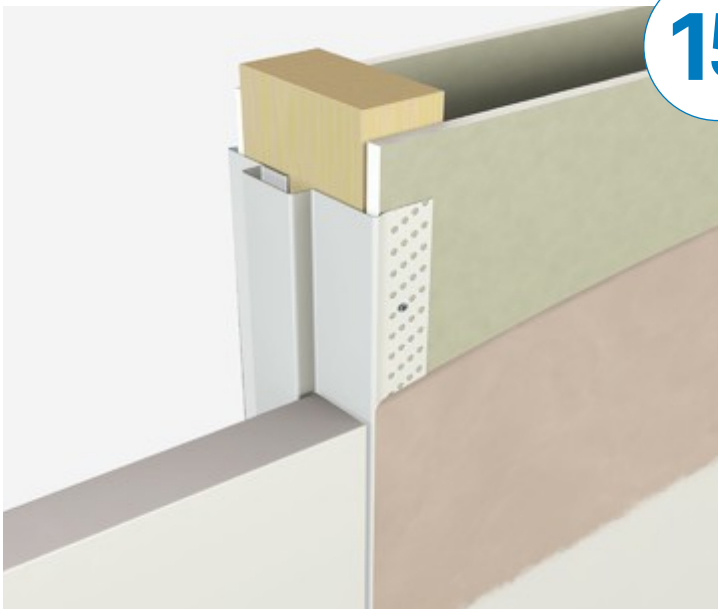

Finish up to the stop bead with multi-finish plaster skim or tape and jointing compound. This conceals the frame and all fixings.

Once the plaster/jointing compound has dried, the wall and frame can be painted. The frame will need a metal primer applied (if supplied unfinished) and can then be painted as required.

15a

FD60s intumescent seal configuration

In order to achieve a FD60s fire rating the 4 sided Una frame requires intumescent seals to be fitted to the door as indicated:

- Sides** 1no. 20×4mm seal with rubber fins
1no. 20×4mm seal
- Head** 1no. 35×6mm seal with rubber fins
- Bottom** 1no. 20×4mm seal with rubber fins
1no. 20×4mm seal
- Double door** 1no. 20×4mm seal with rubber fins
1no. 20×4mm seal to one door leaf meeting stile

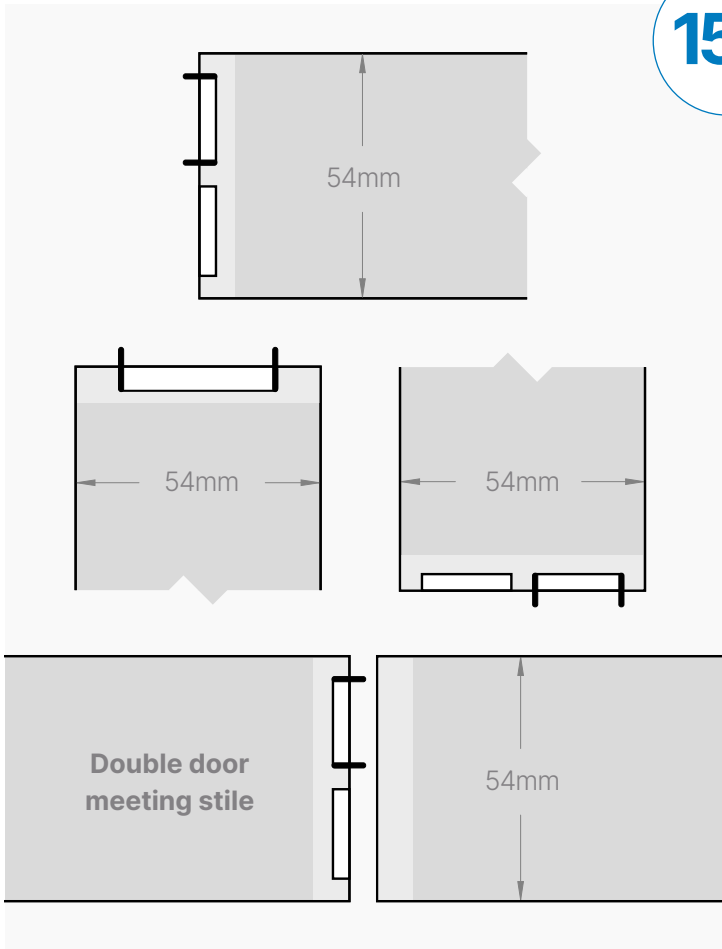

16

Fitting the latch

Fit the latch or lock to the door. Fitting of the strike / latch plate is straight forward as it is surface mounted over the frame via 2 PH2 self-drilling screws.

IMPORTANT

Use a low-torque to avoid turning the screws from the frame.

FIRE CERTIFICATION NOTE

If the doorset is fire rated then the lock or latch used will need to be lined with a 1mm intumescent pad.



Congratulations

You've now completed the installation of your Una concealed frame riser doorset.

Please refer to the following pages for options and adjustments.

Hinge installation



› Butt hinge

Una options

› Fire rating

Butt hinge Position measurements



2 Hinges

Hinge position measurements

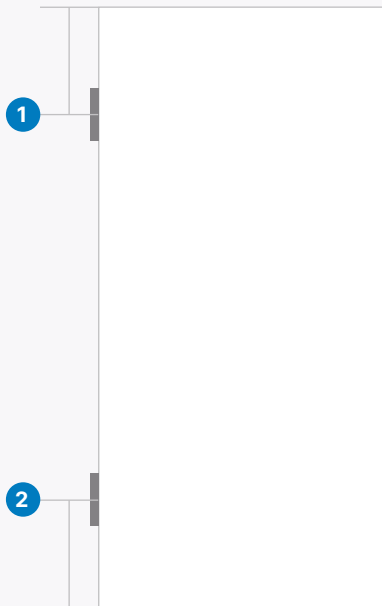

Top of Frame to centre of Hinge 1

1 250mm

Bottom of Frame to centre Hinge 2

3 250mm

3 Hinges

Hinge position measurements

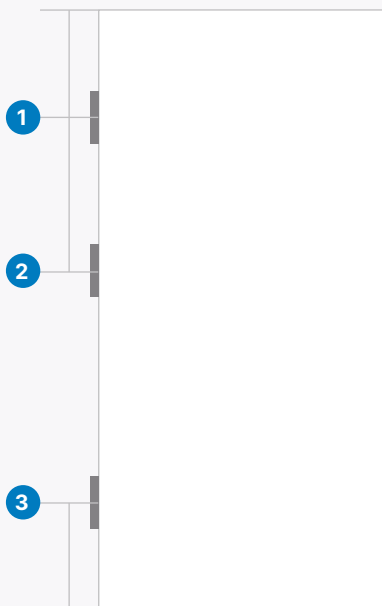

Top of Frame to centre of Hinge 1

1 250mm

Top of Frame to centre of Hinge 2

2 525mm

Bottom of Frame to centre of Hinge 3

3 250mm

4 Hinges

Hinge position measurements

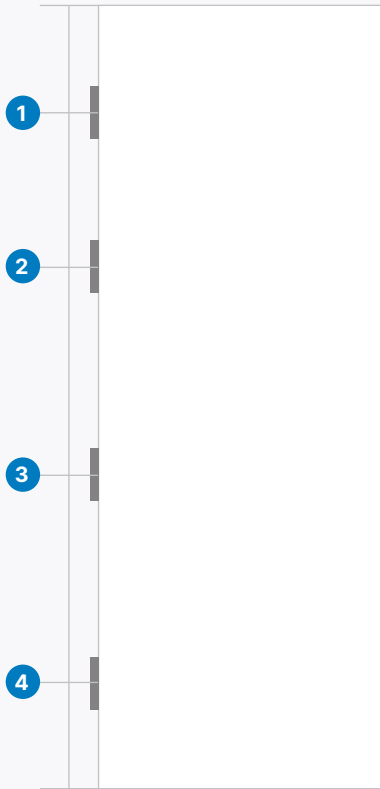

Top of Frame to centre of Hinge 1

1 250mm

Top of Frame to centre of Hinge 2

2 525mm

Fitted centrally between Hinge 2 and Hinge 4

3 Middle of Hinge 2 and 4

Bottom of Frame to centre of Hinge 4

4 250mm

5 Hinges

Hinge position measurements

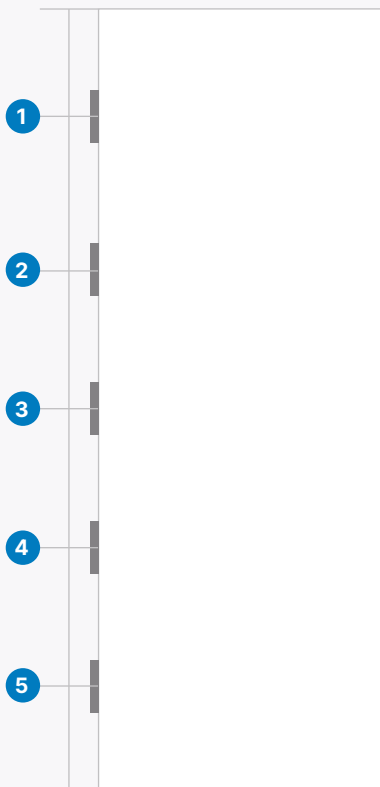

Top of Frame to centre of Hinge 1

1 250mm

Top of Frame to centre of Hinge 2

2 525mm

Fitted equally between Hinge 2 and Hinge 5

3 & 4 Equally spaced between 2 and 5

Bottom of Frame to centre of Hinge 5

5 250mm

Butt hinge

Installation instructions



1

Identify, measure and mark

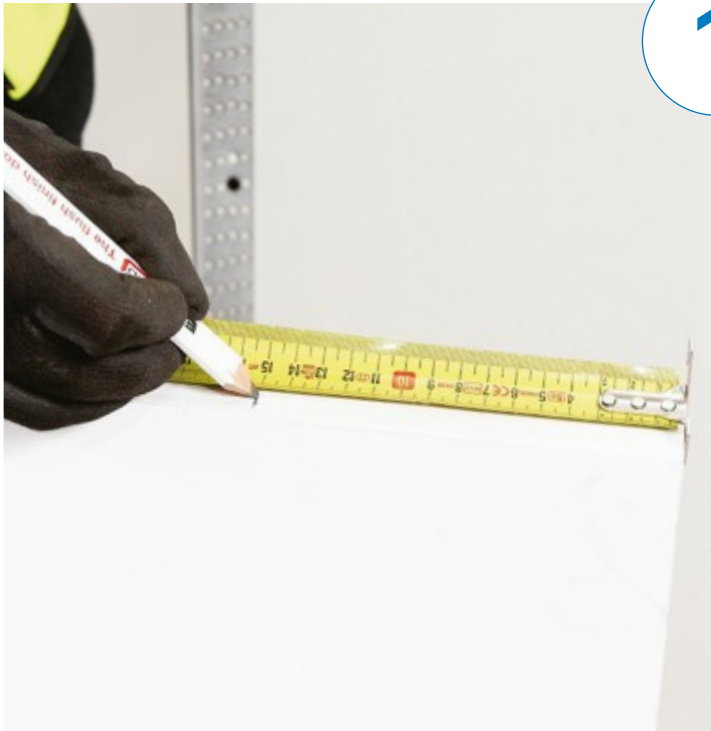

The Selo butt hinges have been specifically designed for the Una doorset. They are designed to be surface mounted to the frame and door.

Start off by marking your hinge centres on the door leaf.

2

Fix hinges

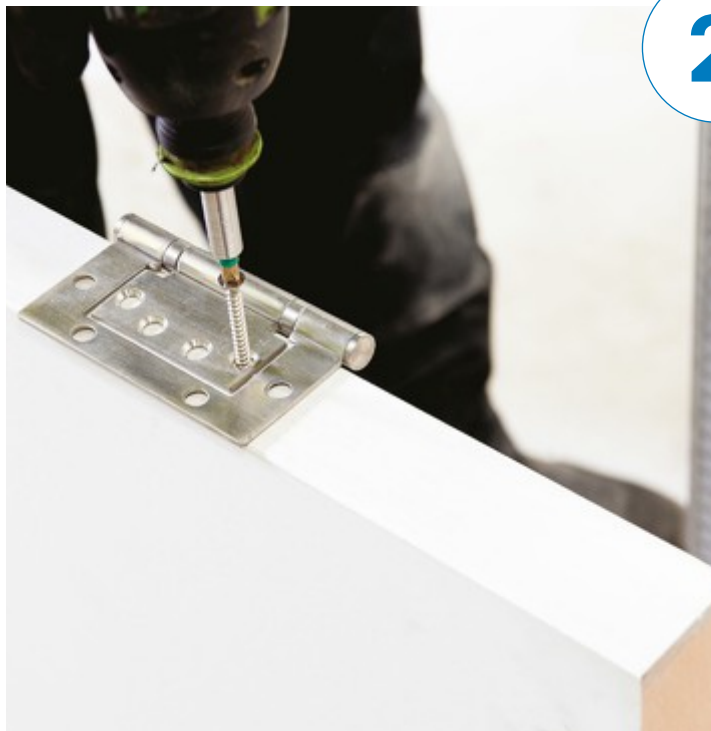

Place the hinge on the door so that the frame leaf is flush with the rear face of the door. Pilot drill and fix through the holes in the smaller leaf of the hinge using the screws provided.

3

Drill holes in frame



With the hinges fitted to the door, stand the door up and take to the door opening. Accurately mark the position of the top hinge on the frame, making an allowance for a 3mm gap at the top.

3a Line the hinges up to the position marked on the frame. Use a 3mm packer between the hinge and the door stop, mark the 4 hole positions.

3b Using a 6mm metal cutting drill bit, drill four clearance holes in the positions marked.

4

Pack behind frame



Position a nominal 3mm packer behind each pair of clearance holes. Making sure the packers are pushed so that they are up against the inside of the plasterbead.

5

Fix hinges to frame

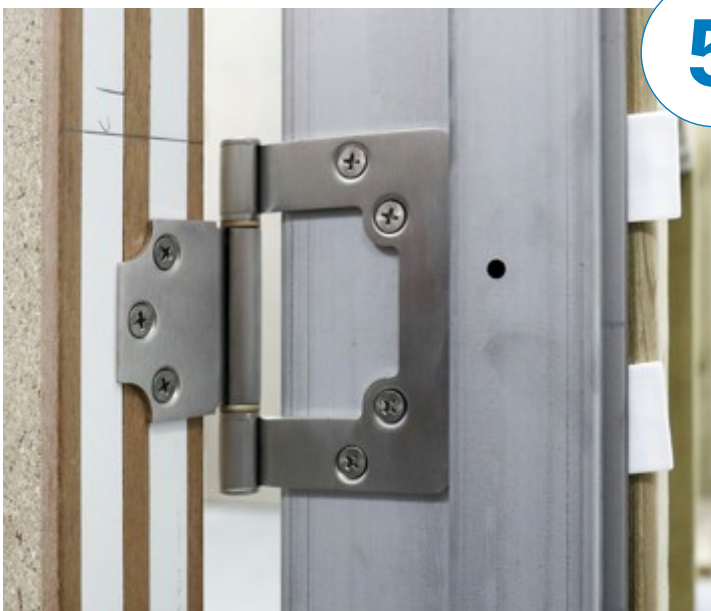

Fix the hinge to the frame with the screws provided making sure the screws pierce the packers.

Fix the all hinges using the fixings provided.

Fire rating

The Una system is available with an FD60 certification when installed using intumescent seals.

Intumescent seals

To achieve the relevant specified fire rating intumescent seals will be provided. Doors will come with the appropriate pre-cut grooves ready for installation.

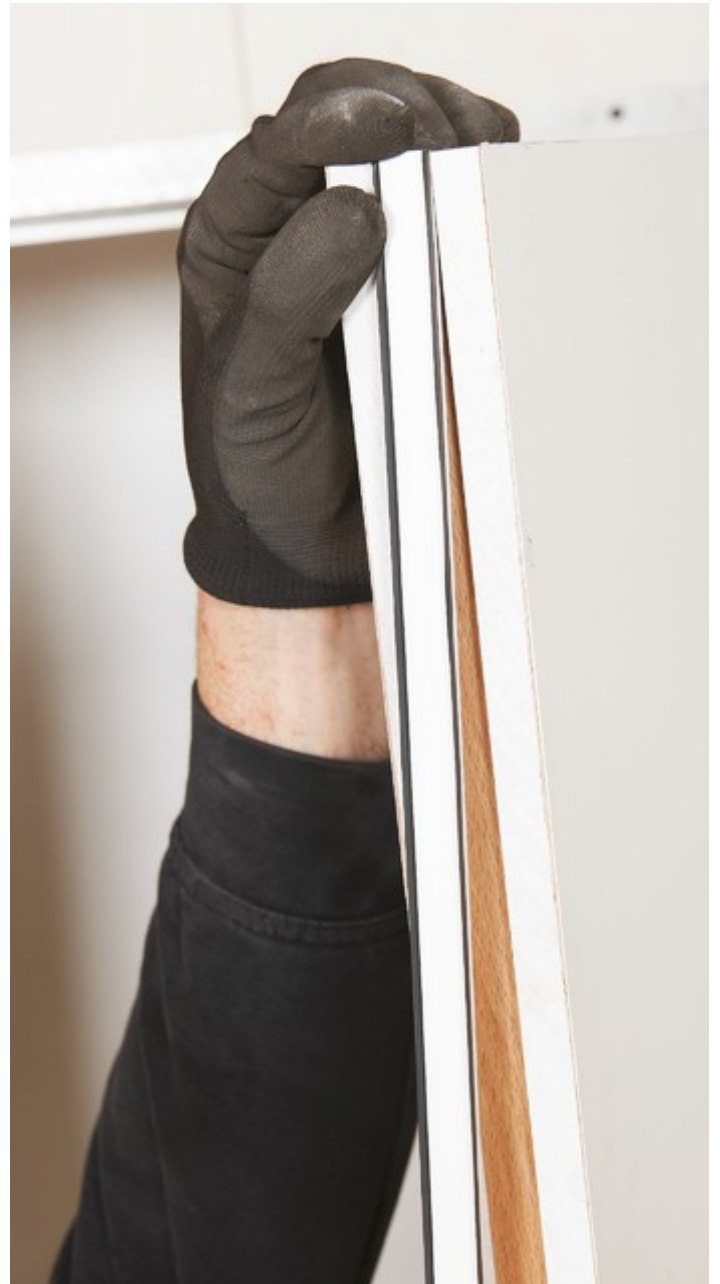

halo
assist

For installation help and advice with your project:
call 020 3880 0339 / **email** sales@selo-uk.com

INSTALLER TRAINING

Hands-on practical installation advice

Complimentary training is provided at our Milton Keynes headquarters. Learn installation tips and tricks directly from the manufacturer; helping improve standards with quality, compliant installations.

SeloAcademy



Scan QR for Video Library
www.selo.global/video-library/

© 2015 by Selo. All rights reserved.

No part of this publication may be reproduced in any material form (including photocopying or storing it in any medium by electronic means and whether or not transiently, or incidentally to some other use of this publication) without the written permission of the copyright owner. Application for the copyright owner's permission to reproduce any part of this publication should be addressed to Selo. Selo reserves the right to alter specification and designs without prior notice.

Rev 1.2 - August 2023
SEL-PRT-01462

Correct storage of Una timber doors

For help and advice with the installation of any Selo products,
call our dedicated support team on **020 3880 0339**

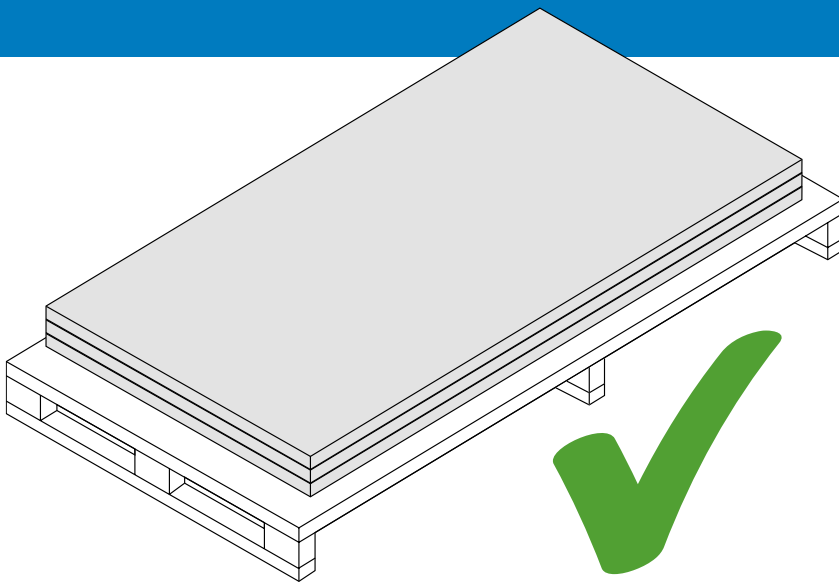

ALWAYS

**Lay the doors FLAT with
the load spread evenly**

Incorrect storage could result in your
doors warping, twisting or bowing.

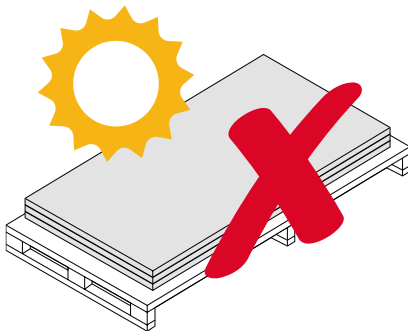

**Avoid excessive
temperatures**

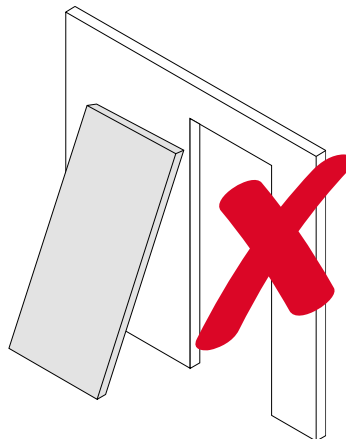

**DO NOT leave doors
leant against wall**

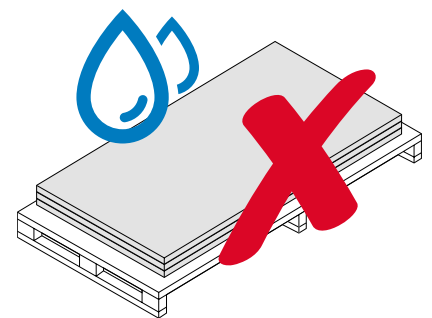

**Avoid moisture and
damp environments**

selo[®]

call 020 3880 0339
email sales@selo-uk.com
www.selo.global

Selo
K2 Kents Hill Business Park Timbold Drive
Milton Keynes MK7 6BZ



Follow us on:

