

halo
assist

Installation supportline:

call 020 3880 0339

selo®

Concealed Frame Doorsets
Riser Doors & AOVs

Ligna®
Plastered

Clad Riser Doorset

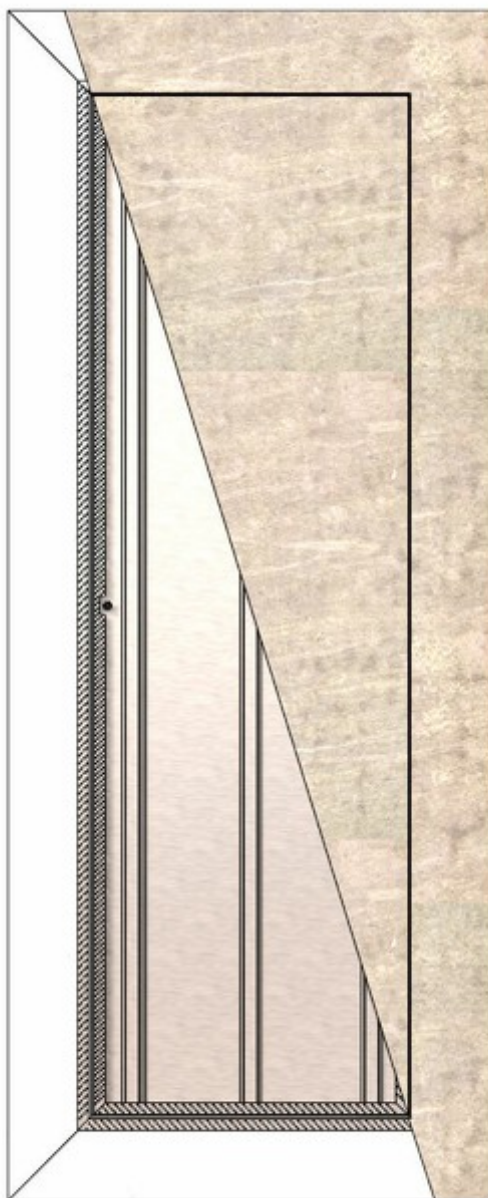

Installation instructions

Thank you for choosing Ligna

To ensure the installation process is simple and efficient we recommended you read this guide in full before you begin.

Tools required

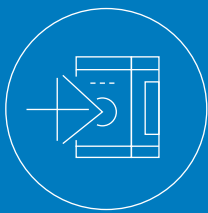

Laser level

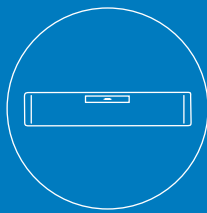

Spirit level

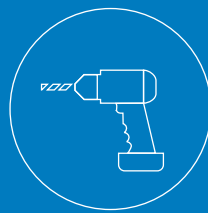

Cordless screwdriver

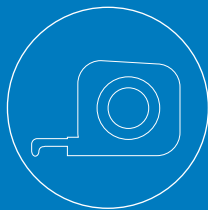

Tape measure

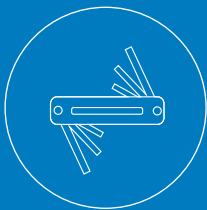

Hex keys (metric)

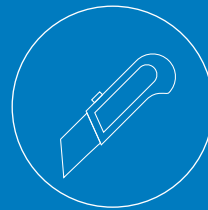

Knife

IMPORTANT - Fire rating notice

The fire rating of any doorset is subject to a number of factors, including:



1. The design/workmanship of other work, in particular the partitions into which the doorset is fixed.)
2. The doorset being installed in accordance with the installation instructions.

The Ligna system can be fitted to either studwork or masonry walls, you will need to ensure the wall itself meets the correct fire resistance performance.

Please consult Selo for advice and guidance to ensure the fire performance is met.

tel 020 3880 0339 **email** sales@selo-uk.com

Installation guidance

Before installation, please ensure you have carried out the recommendations below.

Wall preparation

The wall construction will need to be constructed to suit the fire rating specified. If using a steel stud partition then a timber insert on the four sides of the opening needs to be fitted to ensure sufficient purchase with the fixings.

IMPORTANT

Some shaft wall partitions will not require the timber insert, please consult Selo for guidance and advice.

Delivery

The Ligna doorset will come fully protected with polystyrene corners and heat shrink wrapped in heavy duty polythene. Ensure the door specifications shown on the printed label correspond with your project schedule.

IMPORTANT

When fitting a single doorset the frame and doors will be supplied as one. On double and multi doorsets the frame and doors are supplied separately.



1

Check opening

It is very important to ensure that the opening is square, and level and the opening dimensions are correct. Use a laser level to achieve this.

IMPORTANT

Use the structural opening dimensions supplied on the Selo door schedule. If in doubt please call Selo on 020 3880 0339 where we will be glad to assist!

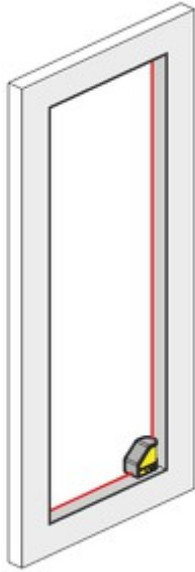

2

Prepare opening

Remove material from the top of the frame to allow for the top pivot - Marked 1 on image.

Depending on the frame adjustment, you may need to remove a small amount of material for the top and bottom lock bars as well as the hinge side dog bolts - Marked 2 on image.

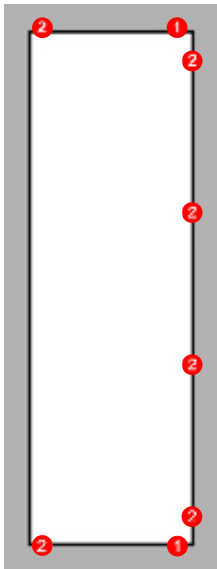

3

Place doorset in opening

Place three or four 5mm packers on the threshold at least 50mm away from the side studs.

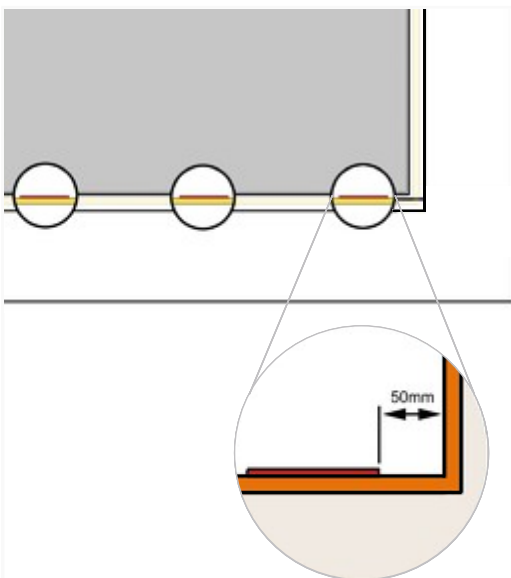

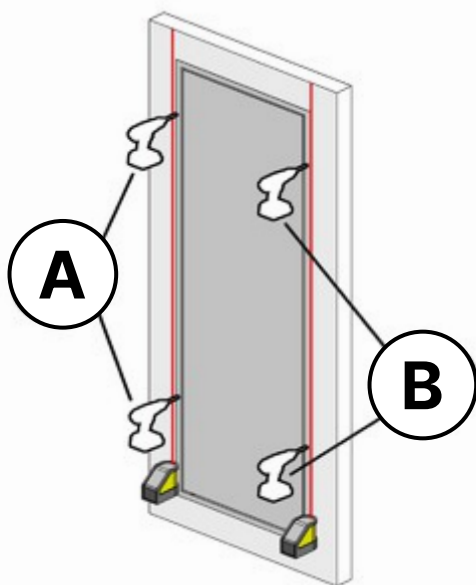

4

First fixings

A Plumb the hinge side with a spirit or laser level and fix into place through the perforated flange with 4-6 screws depending on the height of the door.

B Ensure there is a consistent gap all the way around and fix through the opposite perforated flange in the same way.

5

Check door operation

Open and close the door to ensure the frame and door do not rub or catch anywhere.

Adjust frame if necessary by removing screws and re-fixing once adjusted.

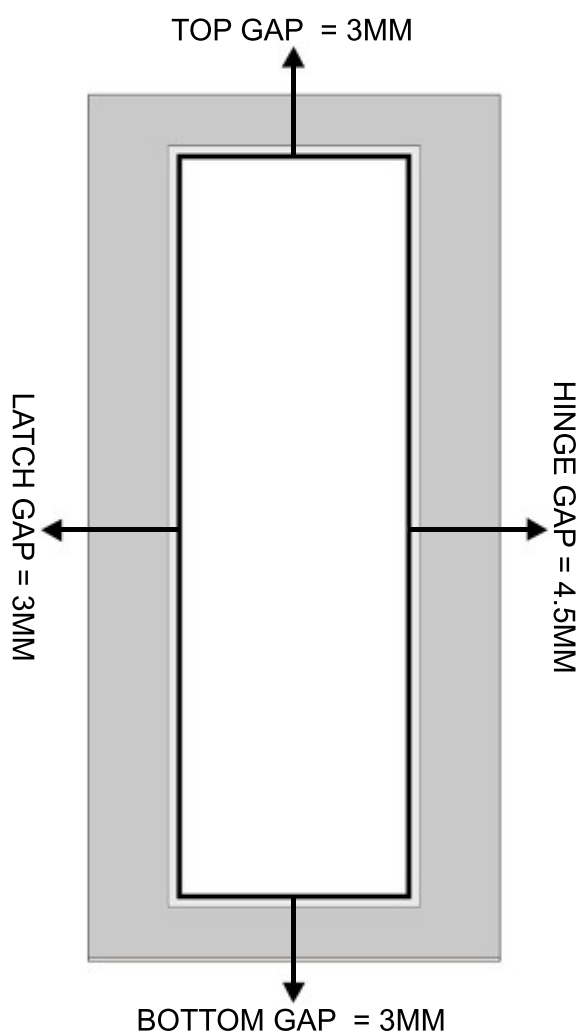

6

Frame fixings

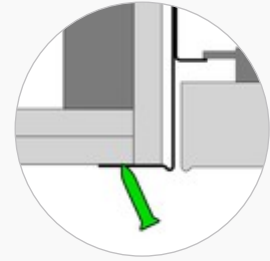
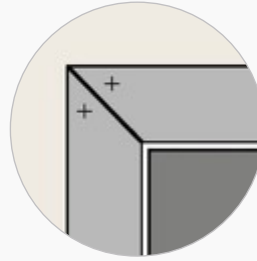
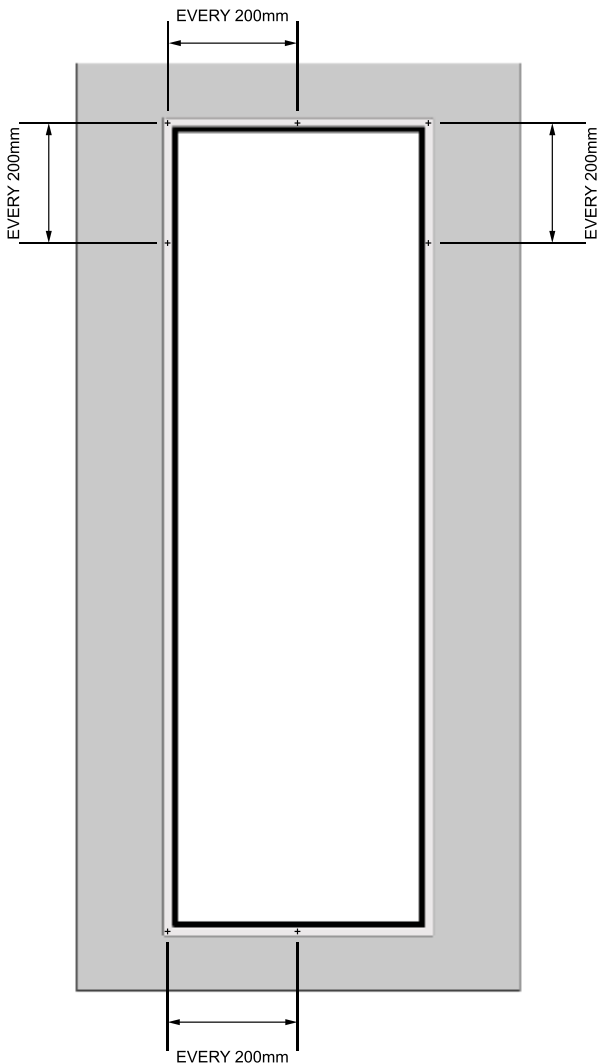

Fix at least every 200mm around the frame through the perforated flange. Ensure to screw a fixing at each corner of the frame.

If the door gap is too large / small - by angling the screws when fixing - this can pull the profile in or out to adjust the door gap.

IMPORTANT

Use 80mm long screw fixings.

7

Remove the door from the frame

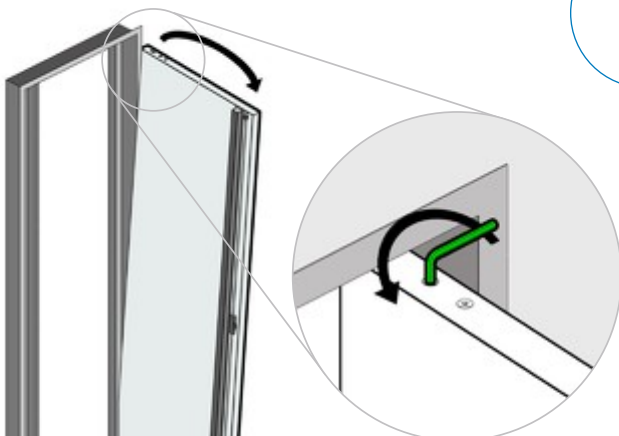

Open the door to 90° and take the weight off the pivot. Unwind the hex head screw as far as it will go (anticlockwise) to allow the top pivot pin to drop flush into the door. Tap the hex head screw down to free pivot pin if it is tight.

With assistance lift the door up off the bottom pin and remove.

IMPORTANT

Double/Multi doors are supplied separate to the frame so do not require removal.

8

Final frame fixing

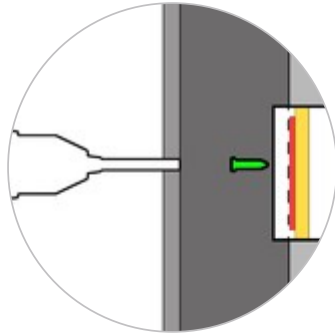
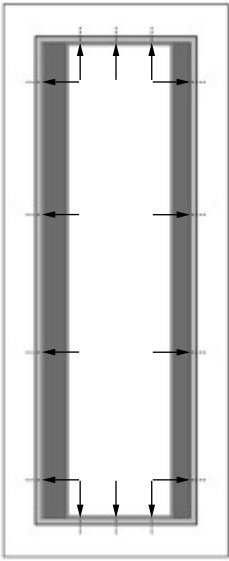

Finally, once the perforated flange has been secured around the frame, fixings need to be made through the frame. Ensure packing behind each fixing to prevent frame distortion as the screw is tightened.

IMPORTANT

When packing the frame combustible and non combustible packers are suitable. The packers need to be trimmed back to allow them to be covered by the intumescent mastic (Step 15). Use 80mm long screw fixings. **DO NOT** use expanding foam to install the doorset unless approved by Selo.

9

Fit door(s)

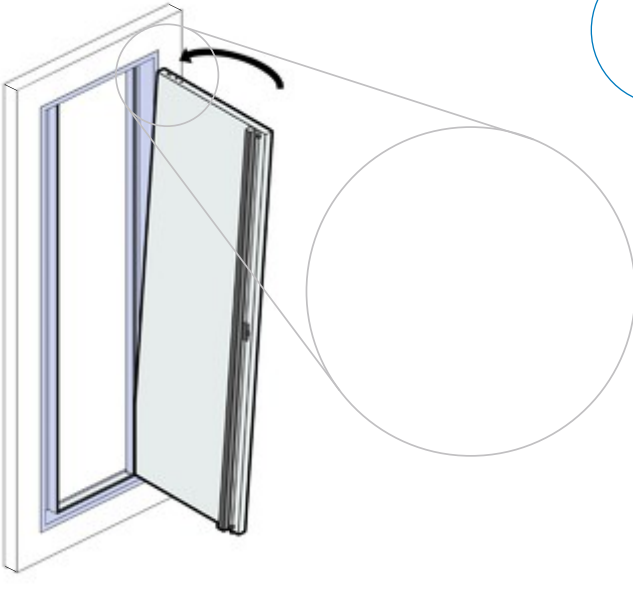

With assistance lift the door(s) up on its end and locate the bottom socket over the pivot pin shown.

Take the weight of the door and wind the hex head screw as far as it will go (clockwise) to allow the top pivot to extend upwards into the head.

IMPORTANT

Check top pivot pin is engaged in the pivot hole in the frame before fully winding the hex head screw.

10

Tape & Joint / Plaster

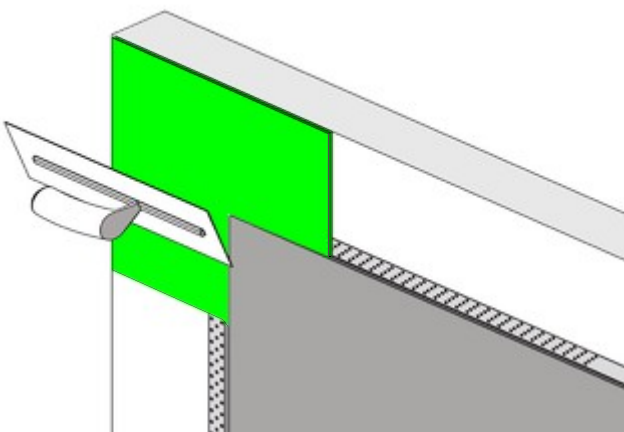

If a fire rating has been specified, 'Mann McGowan Pyromas A' or an intumescent mastic that has been tested in the same situation should be applied all around the back edge of the frame, as shown in the diagram.

IMPORTANT

If packers have been used they must be trimmed back to enable them to be covered by the intumescent mastic. **DO NOT** use expanding foam to install the doorset unless approved by Selo.

11

Sealing for fire rating

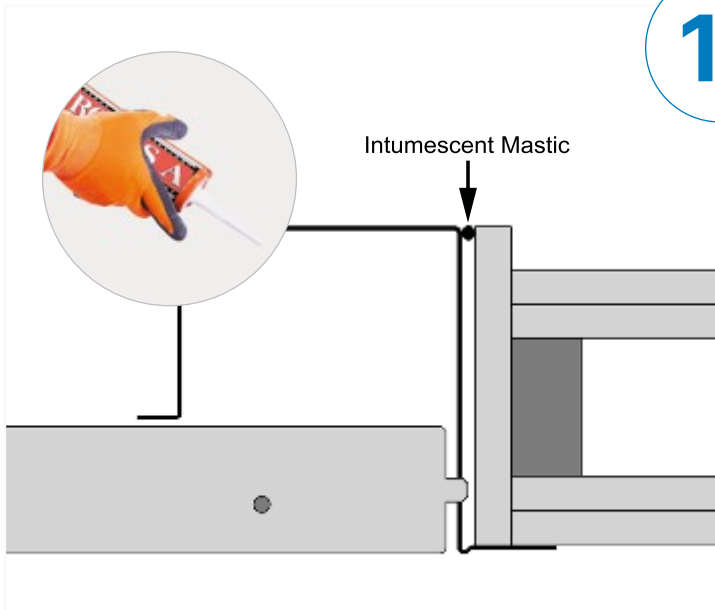

If a fire rating has been specified, '**Mann McGowan Pyromas A**' or an intumescent mastic that has been tested in the same situation should be applied all around the back edge of the frame, as shown in the diagram.

IMPORTANT

If packers have been used they must be trimmed back to enable them to be covered by the intumescent mastic.

DO NOT use expanding foam to install the doorset unless approved by Selo.

12

Plaster around the lock

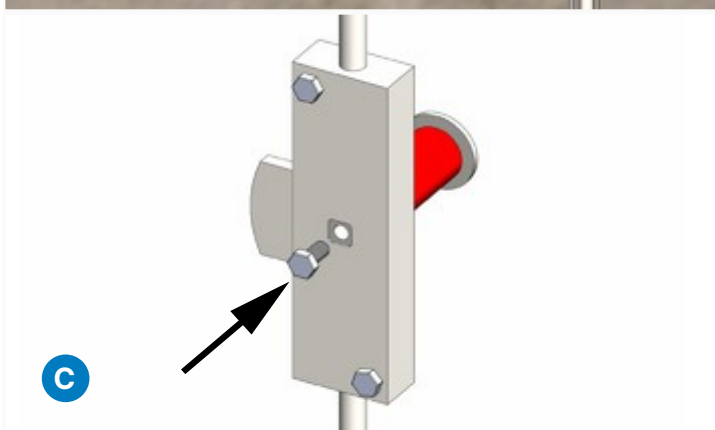
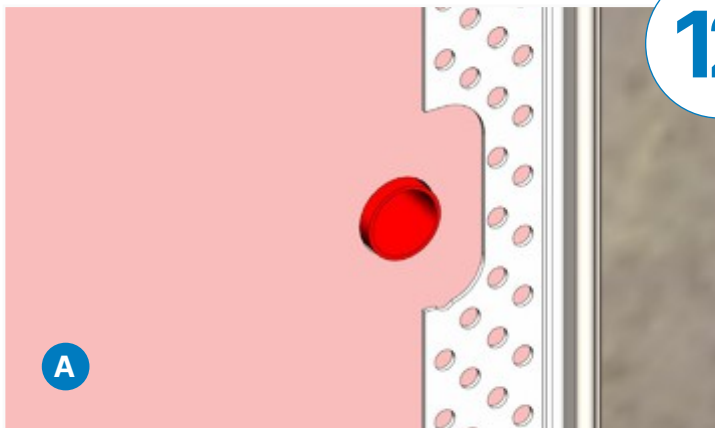

A Remove the lock insert (if assembled) and insert the plaster guide tube through the hole in the plasterboard. Ensure it is fully inserted, this will give you a hard edge to plaster up to.

B Once plastered place the lock insert through the plaster guide tube.

C Fix into the lock housing with the bolt provided to complete the installation.



Operating the lock

Ligna comes pre-fitted with a 3 point locking system.

1

Standard lock

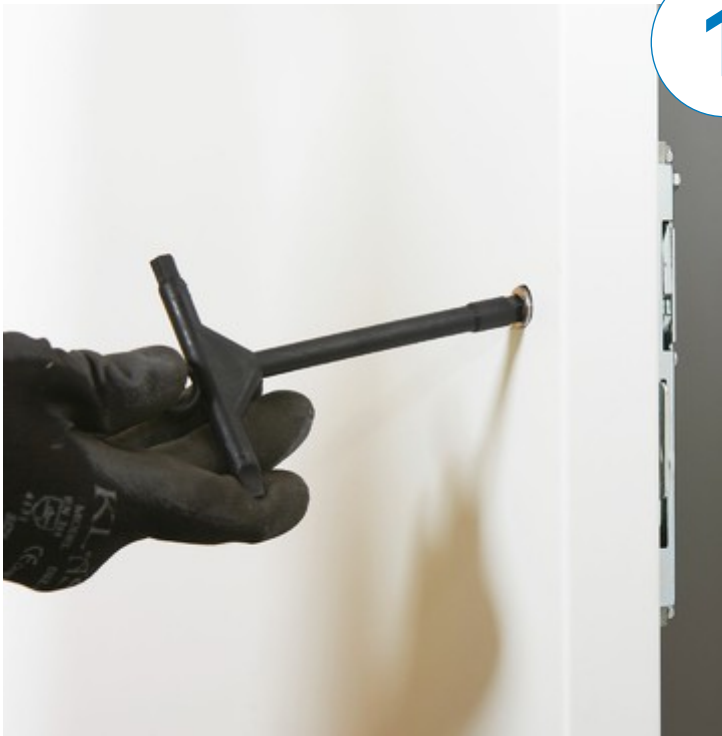

The Ligna doorset uses a 3 point locking system operated by a square drive key as shown. This is provided already fitted to the door.

Ensure full engagement top and bottom of the locking bars into the frame. Adjust if required.



1.1 Centre lock mechanism



1.2 Base locking pin



1.3 Head locking pin



Euro cylinder installation

For high security situations the Ligna locking system can be provided with a provision for a euro cylinder.

1

Select cylinder to suit your application

	X	Y	Z
Tile	65mm + Tile thickness	55mm + Tile thickness	10mm

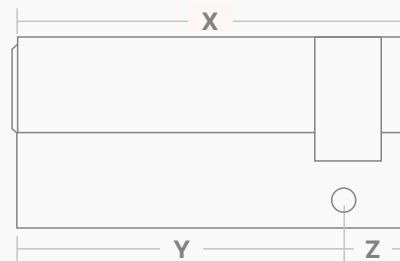

2

Fix the cylinder in place

The cylinder is held into place using the long location screw supplied with the cylinder.

IMPORTANT

The screw provided will need to be cut down by 20mm in length.

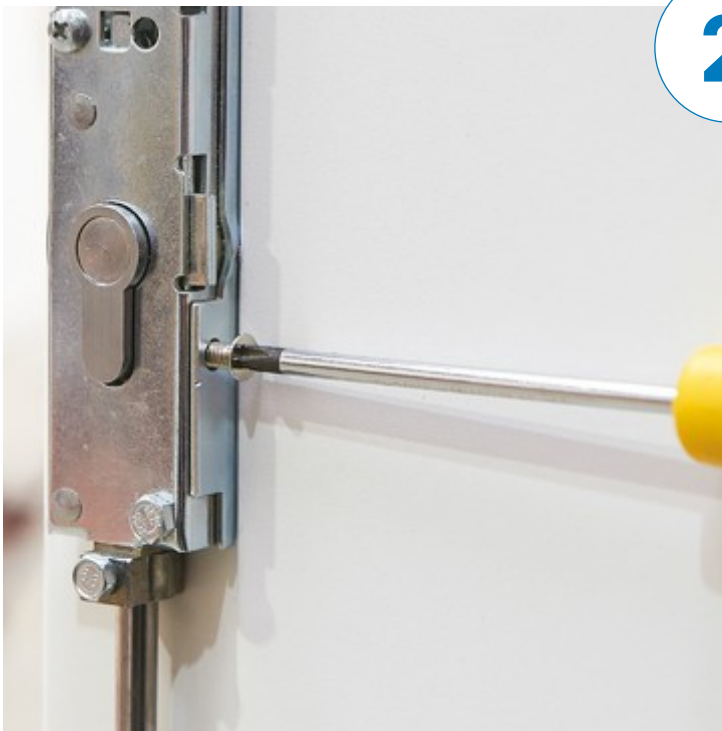
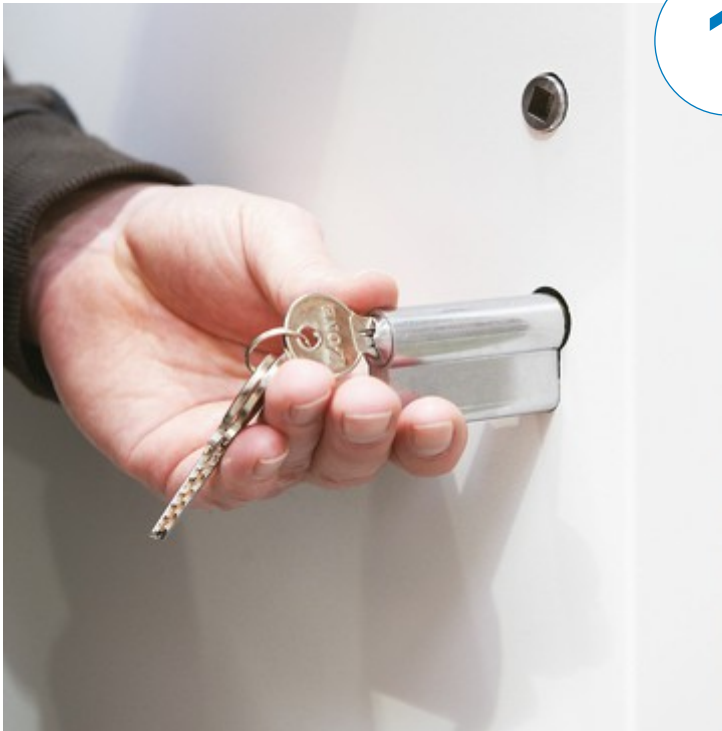

3

Fitting the latch



To activate the cylinder the activation screw needs to be removed from the back of the lock as shown.

IMPORTANT

Only do this once ready to be used as the activation cannot be reversed.

4

Check operation

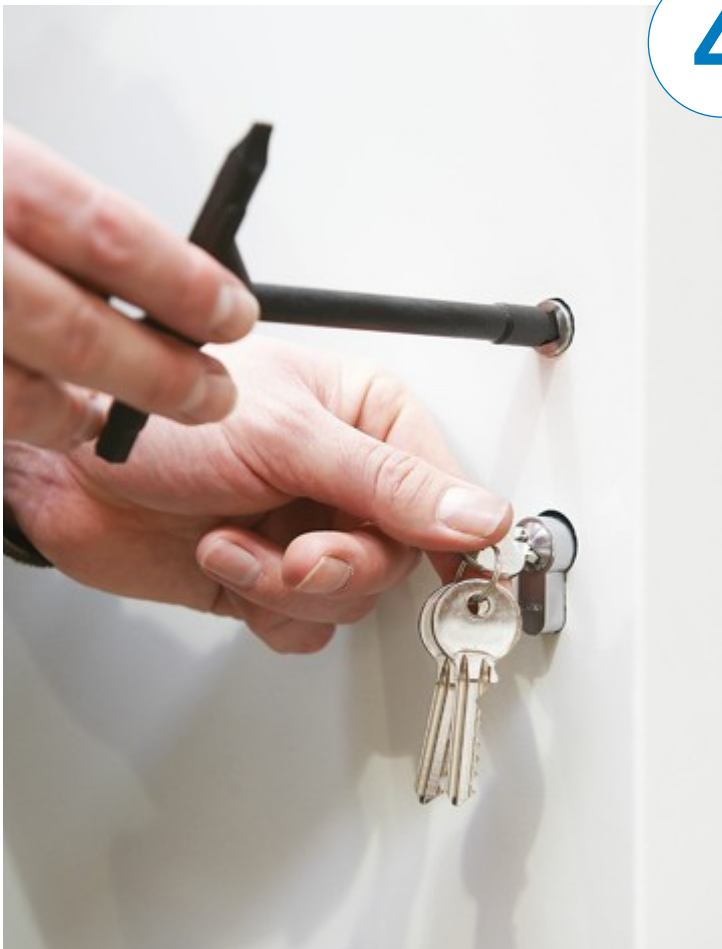

The 3 point lock can only be operated while the key is turned in the cylinder.

The key cannot be removed from the lock until the 3 point lock has been turned to the lock position.



For installation help and advice with your project:

call 020 3880 0339 / **email** sales@selo-uk.com

INSTALLER TRAINING

Hands-on practical installation advice

Complimentary training is provided at our Milton Keynes headquarters. Learn installation tips and tricks directly from the manufacturer; helping improve standards with quality, compliant installations.



Scan QR for Video Library
www.selo.global/video-library/

For installation support
contact our experienced team:

call 020 3880 0339

email sales@selo-uk.com

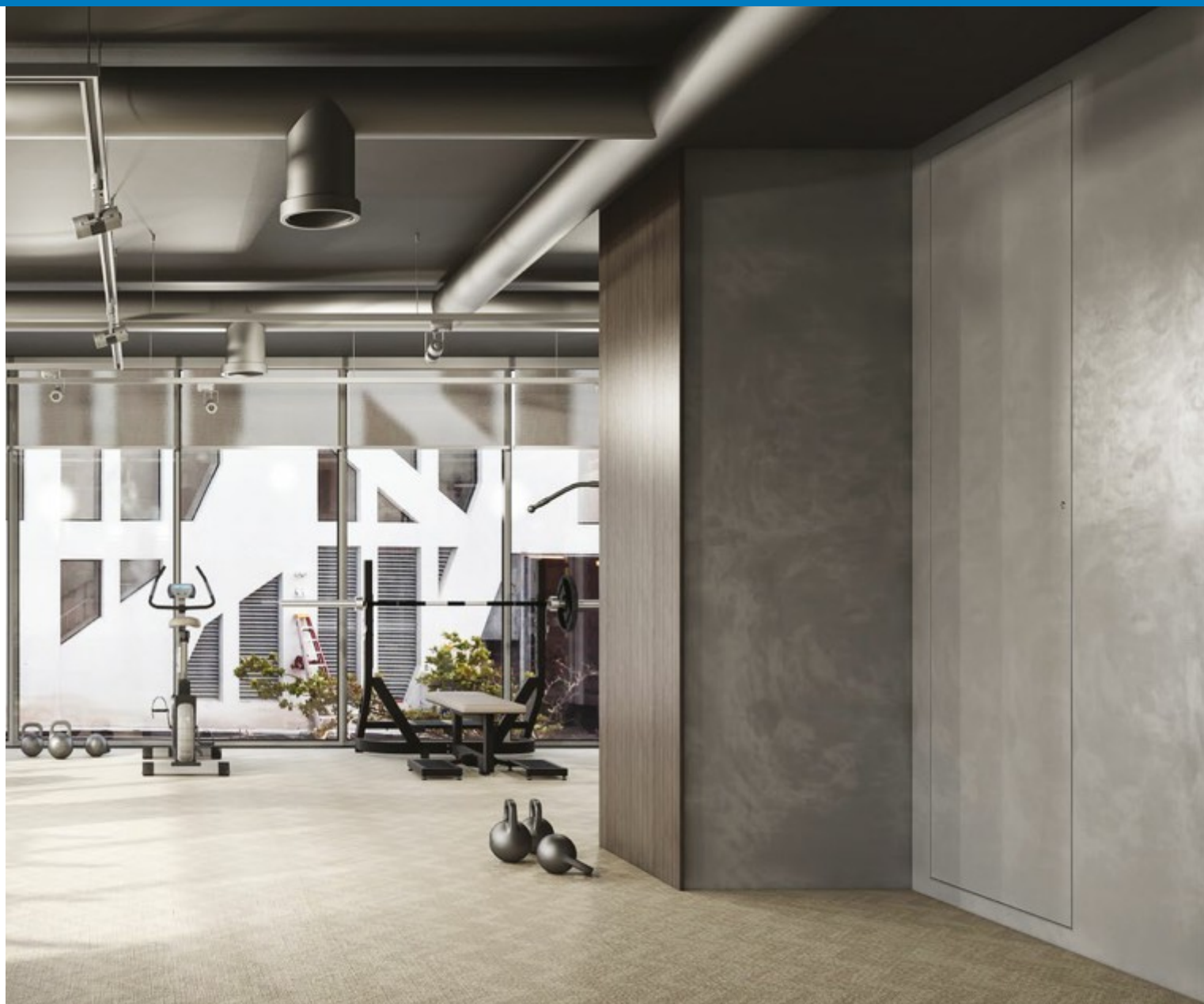

selo®

call 020 3880 0339
email sales@selo-uk.com
www.selo.global

Selo
K2 Kents Hill Business Park Timbold Drive
Milton Keynes MK7 6BZ



Follow us on:

