

halo
assist

Installation supportline:

call 020 3880 0339

selo[®]

Concealed Frame Doorsets
Riser Doors & AOVs

Arriva

Concealed frame doorsets



1

2

Installation guide

Thank you for choosing Arriva

To ensure the installation process is simple and efficient we recommended you read this guide in full before you begin.

Tools required

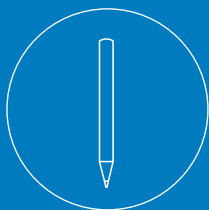

Pencil

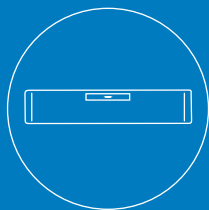

Spirit level

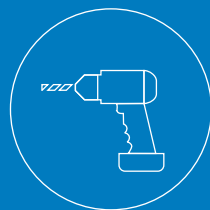

Cordless screwdriver

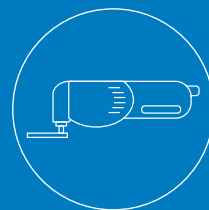

Multitool



Tape measure

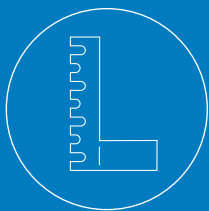

Set square



Knife

IMPORTANT - Fire rating notice

The fire rating of any doorset is subject to a number of factors, including:



1. The design/workmanship of other work, in particular the partitions into which the doorset is fixed.)
2. The doorset being installed in accordance with the installation instructions.

The Arriva system can be fitted to either studwork or masonry walls, you will need to ensure the wall itself meets the correct fire resistance performance.

Please consult Selo for advice and guidance to ensure the fire performance is met.

tel 020 3880 0339 **email** sales@selo-uk.com

Getting started

Before installation, please ensure the system specifications correspond with your project schedule.

Preparing for installation

Your delivery will include one or both of the boxes shown depending on your order.

Ensure you have everything you need prior to installation. Sizes should be checked on the frame box.

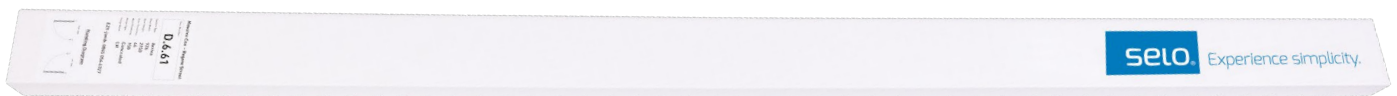

Frame box



Door leaf

What's included

Identify the components below and ensure you have everything prior to installation.

Frame Kit



1 Hinge jamb and corresponding reveal

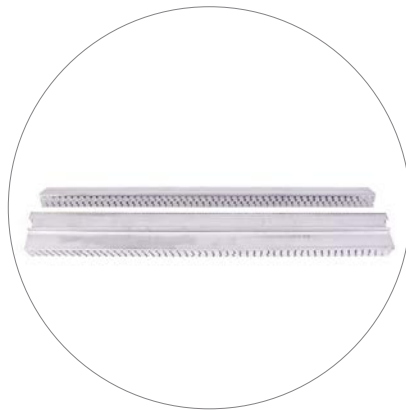

2 Head jamb and corresponding reveal



3 Black plastic head clips



4 Strike plate with plastic insert and fixings



5 Strike jamb and corresponding reveal

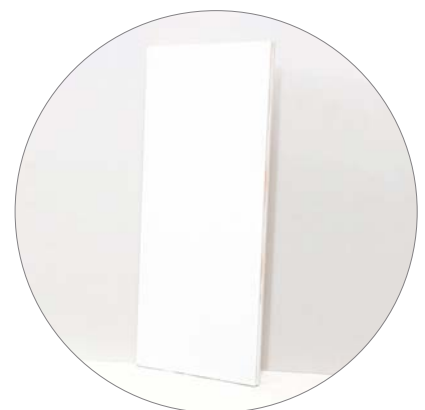

6 Door

Hinge types

Identify your hinge type and ensure all parts are present.

Arriva hinge options



1 Butt hinge



2 ROC-York hinge

Frame installation

Before installation please ensure you have carried out the recommendations in the 'Wall Construction Preparation' booklet.

1

Check opening

Ensure that the opening is square and level and the opening dimensions are correct.

IMPORTANT

If concealed hinges are to be used then the studwork needs to be notched to allow for the hinge.

Details on how to do this are from **page 12** in this booklet.

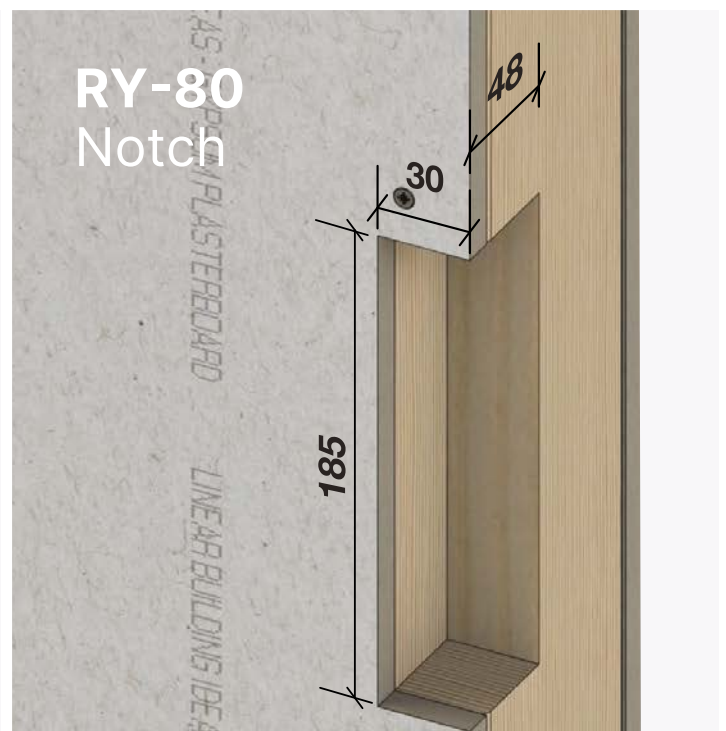
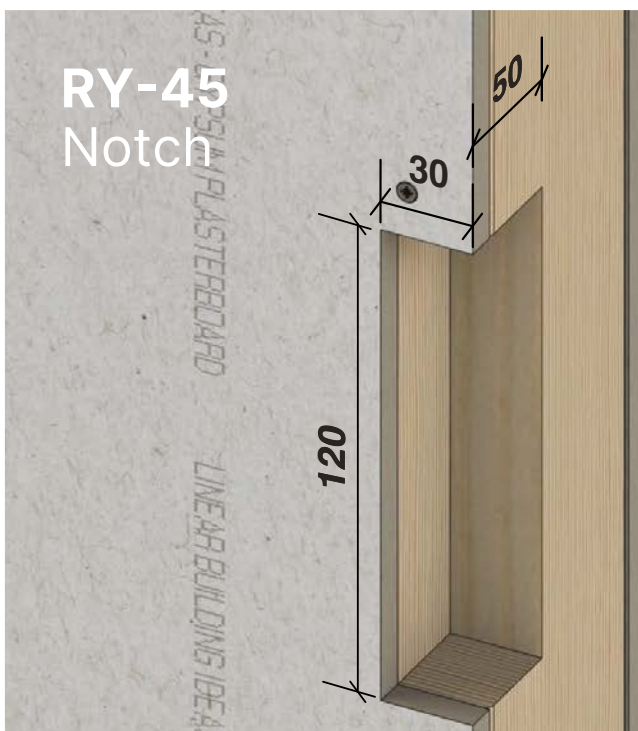
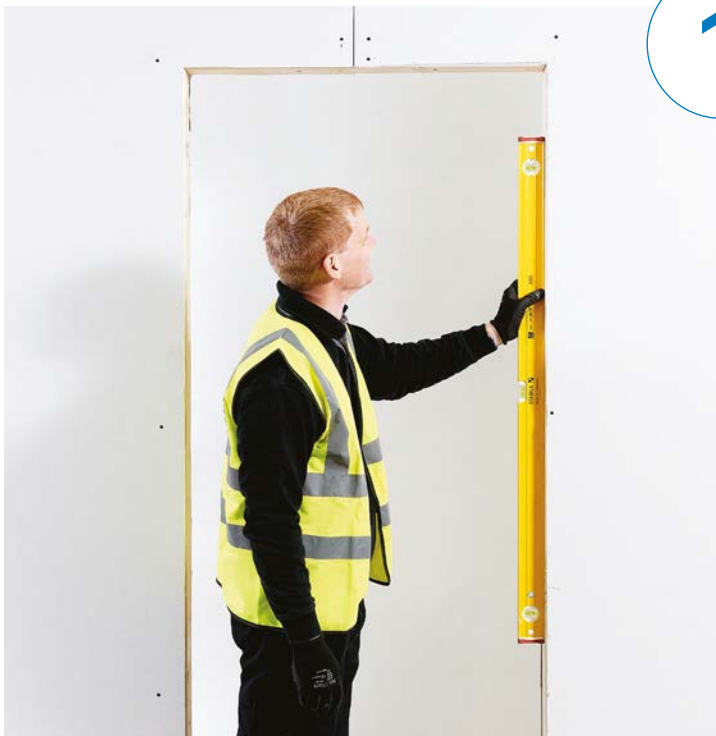

2

Hinge jamb

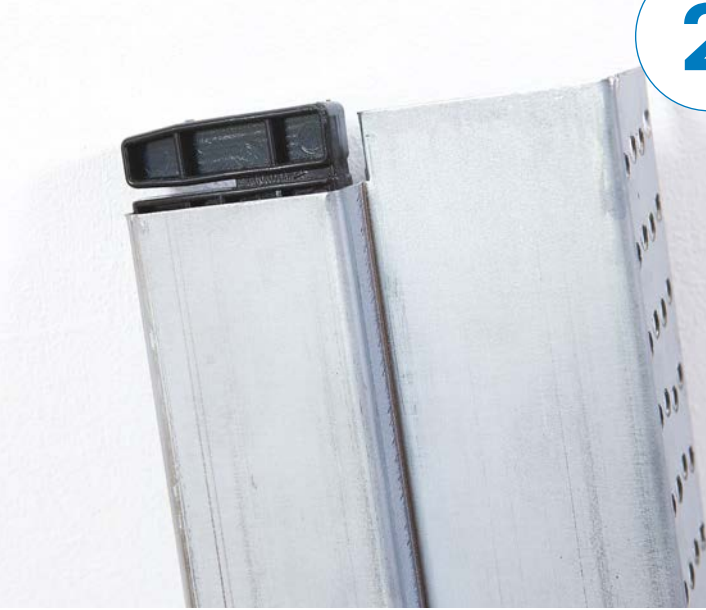

Ensure the black plastic clip is slotted into the top of the hinge jamb with the slot facing away from the perforated edge.

3

Hinge jamb installation



Take the hinge jamb and corresponding reveal and clip together over the wall. Using a level make sure the hinge jamb is plumb and fix into position using 4 drywall screws along the length of the jamb through the perforated flanges.

IMPORTANT

Before installation is complete, further screws will be required. This is covered in Step 9. Do not completely secure frame yet.

4

Head jamb preparation

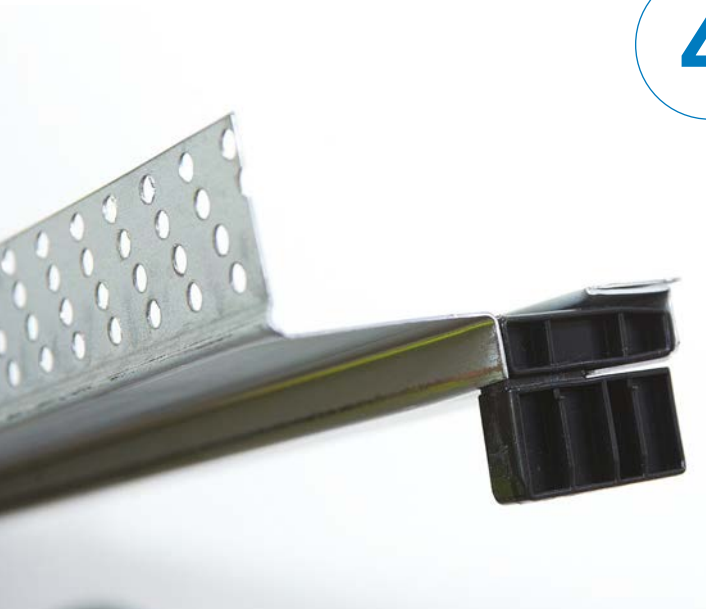

Remove the second black clip from the top of the latch jamb and fit into the latch side of the head jamb.

5

Head jamb installation



Now slot the opposite end of the head into the black clip at the top of the already installed hinge jamb. The side jamb protrudes 2mm higher than the head jamb. Clip its associated reveal into place and once level secure with x2 screws either side.

IMPORTANT

Before installation is complete, further screws will be required. This is covered in Step 9. Do not completely secure frame yet.

6

Latch plate position



Now slot the strike jamb over the black clip located into the head in Step 4.

Before fixing the jamb in position, mark out and mortise the latch stud to accommodate the plastic latch plate insert.



6.1 Mark



6.2 Cut out

Latch plate preparation

6.1 Mark around the latch plate cut-out onto the stud

6.2 Using a multi tool or suitable tool cut out and remove the section of partition

7

Install latch jamb



Now the latch mortise has been made, install the strike jamb in the same manner as the head and hinge jamb.

Ensure the frame is plumb and square. A framing square may be useful at this stage.

7a

Ensure correct installation

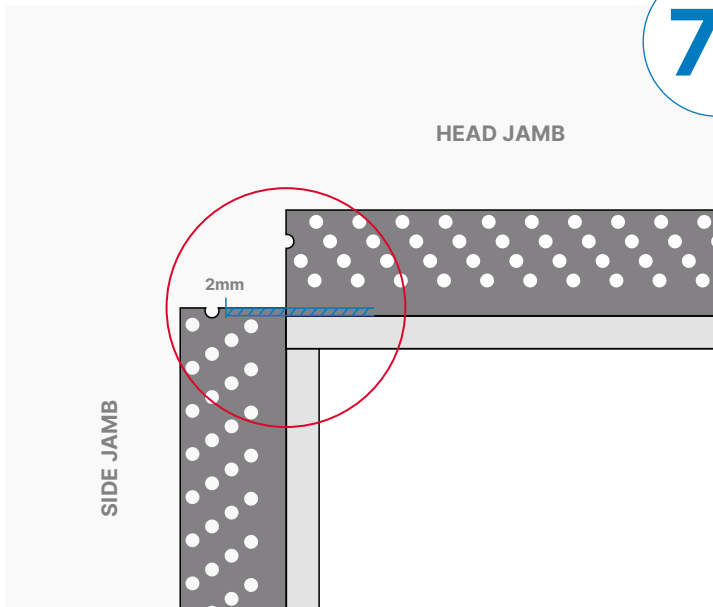
**IMPORTANT**

Ensure the head jamb sits inside the two side jambs 2mm down from the top.

8

Base jamb installation



If the frame being installed is 4 sided, the threshold jamb will need to be installed also.

The bottom of the side jambs will be notched and black plastic clip inserted as shown in the image.

9

Base jamb installation



Insert first one end into the corner clip and then the other. Ensure it is sitting square and fix into place using x2 screws either side.

10

Level-up

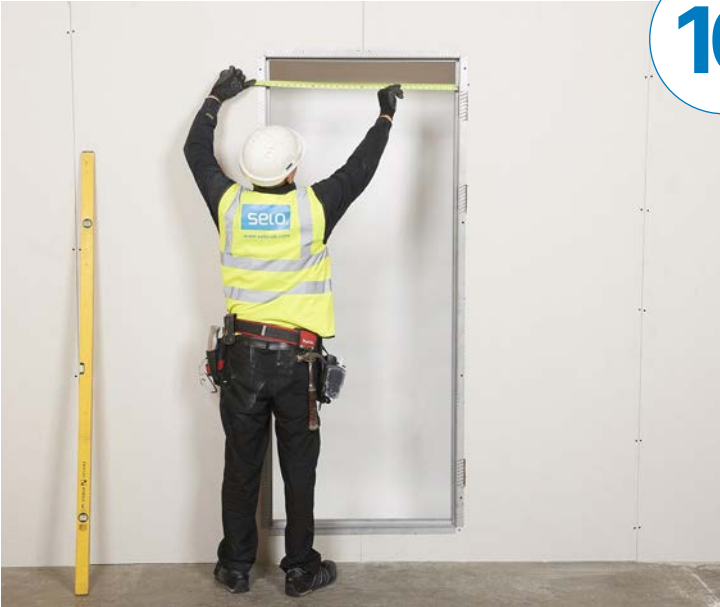

Now ensure the frame is fully level, plumb and square.

11

Hang the door leaf



If you have the door leaf hang the door to ensure it swings correctly and the gaps are correct. If you do not have the door leaf yet, ensure the side jambs are plumb and parallel and the head is level and square.

IMPORTANT

Refer to the hinge Installation guide from page 13 in this booklet.



12

Fix every 200mm

Check the perforated side flanges sit flat against the plasterboard and screw at 200mm increments around the frame through the flange into the studwork.

Double screw all the ends of the frame as shown.



13

Double screw

A double screw is required above and below the hinge, this applies to all hinge types.



14

Plaster tape

Apply plaster fibre tape to the top corners at 45 degrees.

IMPORTANT

If using concealed hinges you will need to apply 2 layers of plaster tape over the hinge jamb.



15

Plastering / Decoration

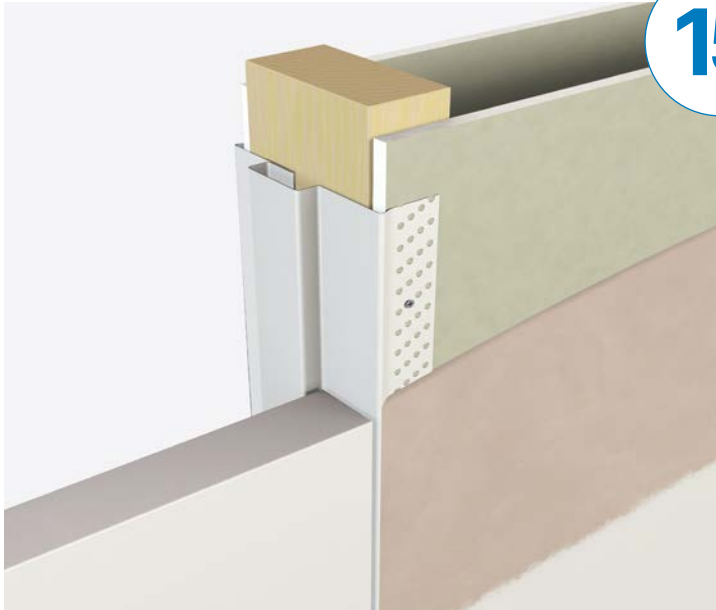

If using butt hinges the door and hinges must be fitted before the reveal is fitted and plastered.

Finish up to the stop bead with multi-finish plaster skim or tape and jointing compound. This conceals the frame and all fixings. Once the plaster/jointing compound has dried, the wall and frame can be painted. The frame will need a metal primer applied (if supplied unfinished) and can then be painted as required.

16

Re-hang door leaf



The door can now be hung.

16a

FD30s intumescent seal configuration

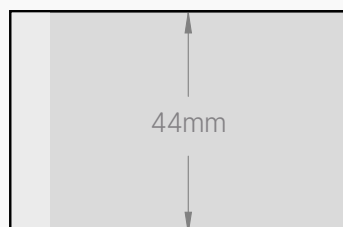
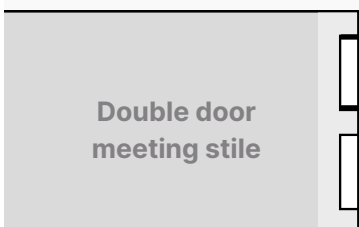
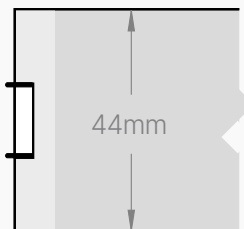
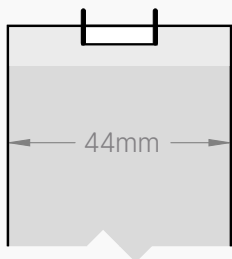

In order to achieve a FD30s fire rating the 3 sided Arriva frame requires intumescent seals to be fitted to the door as indicated:

- Head** 1no. 15×4mm seal with rubber fins
- Sides** 1no. 15×4mm seal with rubber fins
- Double door** 1no. 15×4mm seal with rubber fins
1no. 15×4mm seal to one door leaf meeting stile

16b

FD60s intumescent seal configuration

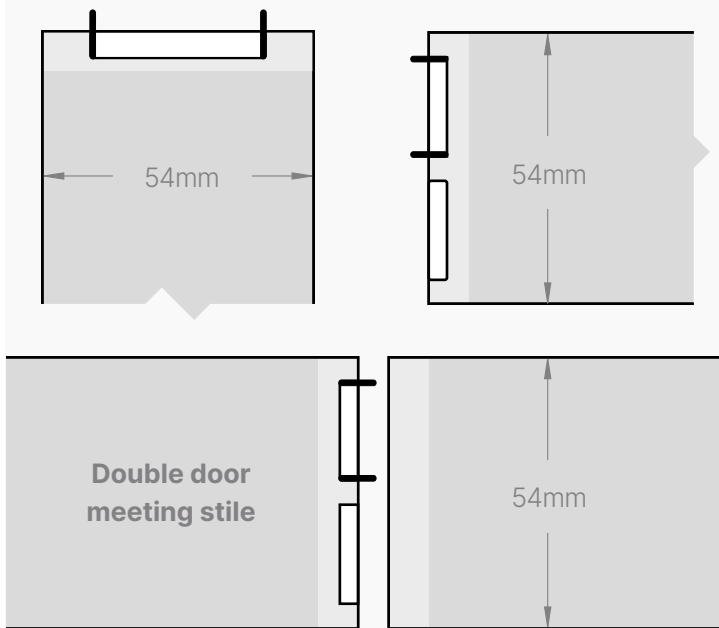

In order to achieve a FD60s fire rating the 3 sided Arriva frame requires intumescent seals to be fitted to the door as indicated:

- Head** 1no. 35×6mm seal with rubber fins
- Sides** 1no. 20×4mm seal with rubber fins
1no. 20×4mm seal
- Double door** 1no. 20×4mm seal with rubber fins
1no. 20×4mm seal to one door leaf meeting stile

17

Fitting the latch



Fit the latch or lock to the door. Fitting of the latch plate is straight forward as it is surface mounted over the frame via 2 PH2 self-drilling screws.

IMPORTANT

Use a low drill torque to avoid turning the screws in the frame.

FIRE CERTIFICATION NOTE

If the doorset is fire rated then the lock or latch used will need to be lined with a 1mm intumescent pad. If a double door then any flush bolt used will need lining with a 1mm intumescent pad.

Congratulations

You've now completed the installation of your Arriva concealed frame.

Please refer to the following pages for installing the two available hinge configurations and the optional Self-closer.

Installation Guides

› Butt hinge

› ROC-York hinge

› Self-closer

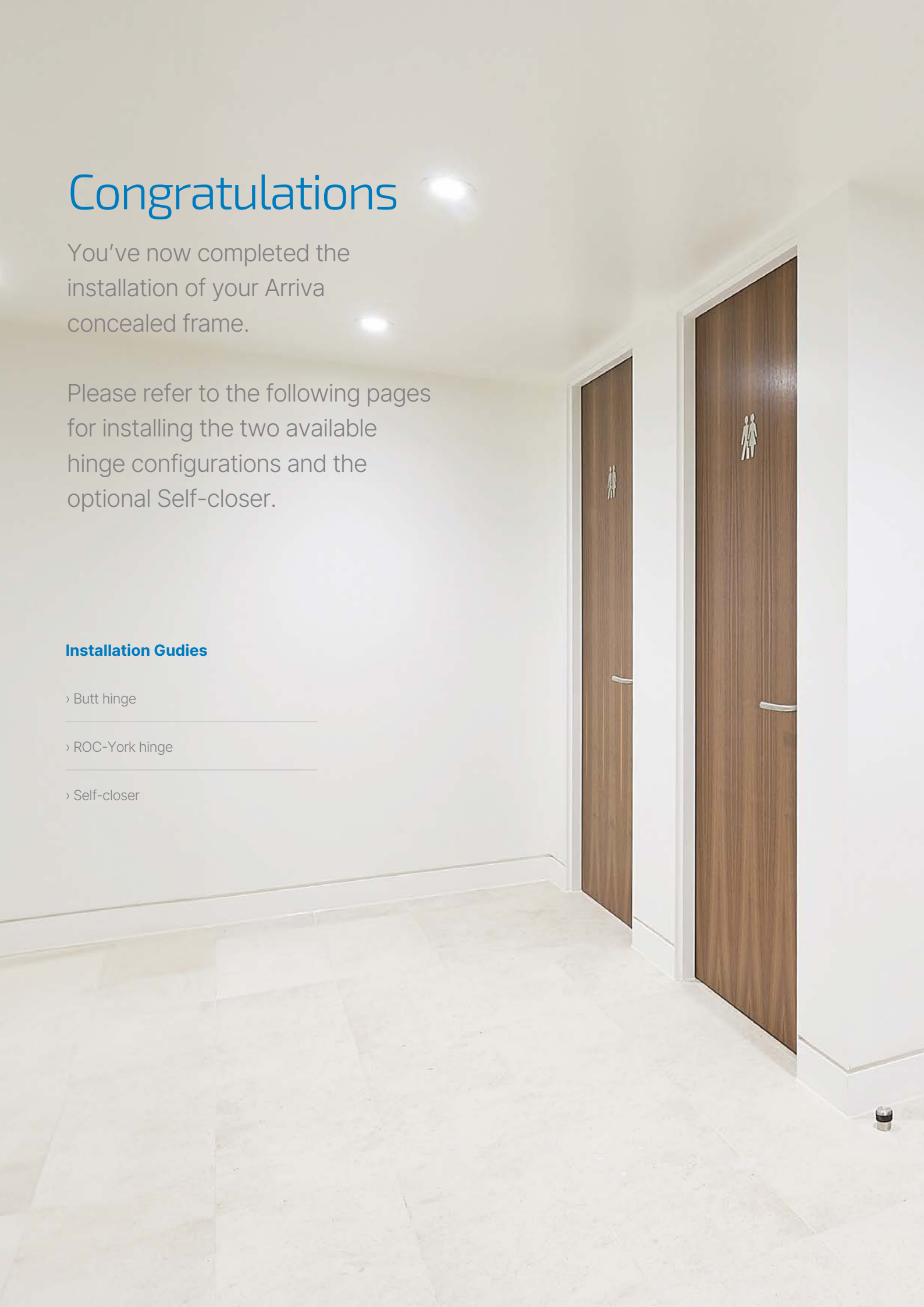



Butt hinge

Position measurements



3 Hinges

Hinge position measurements

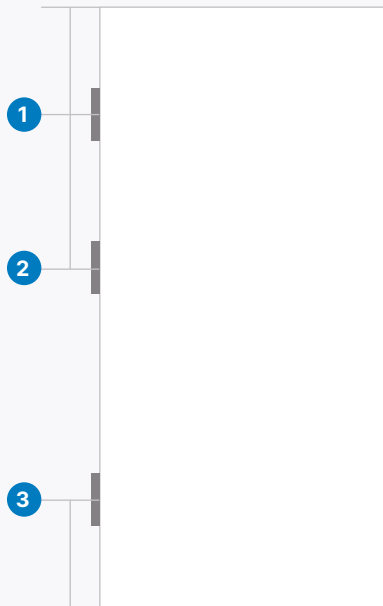

Top of Frame to centre of Hinge 1

1 250mm

Top of Frame to centre of Hinge 2

2 525mm

Bottom of Frame to centre Hinge 3

3 250mm

4 Hinges

Hinge position measurements

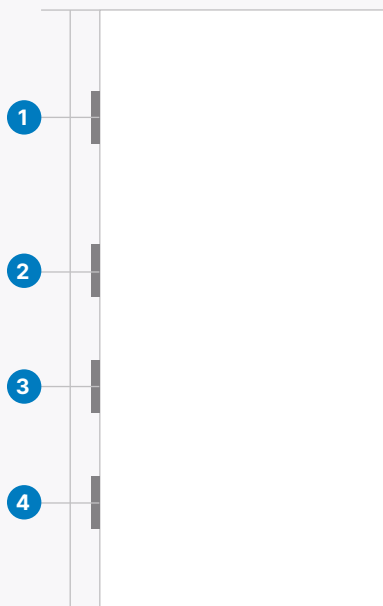

Top of Frame to centre of Hinge 1

1 250mm

Top of Frame to centre of Hinge 2

2 525mm

Fitted centrally between Hinge 2 and Hinge 4

3 Middle of Hinge 2 and 4

Bottom of Frame to centre of Hinge 4

4 250mm

Butt hinge

Installation guide



1

Identify, measure and mark

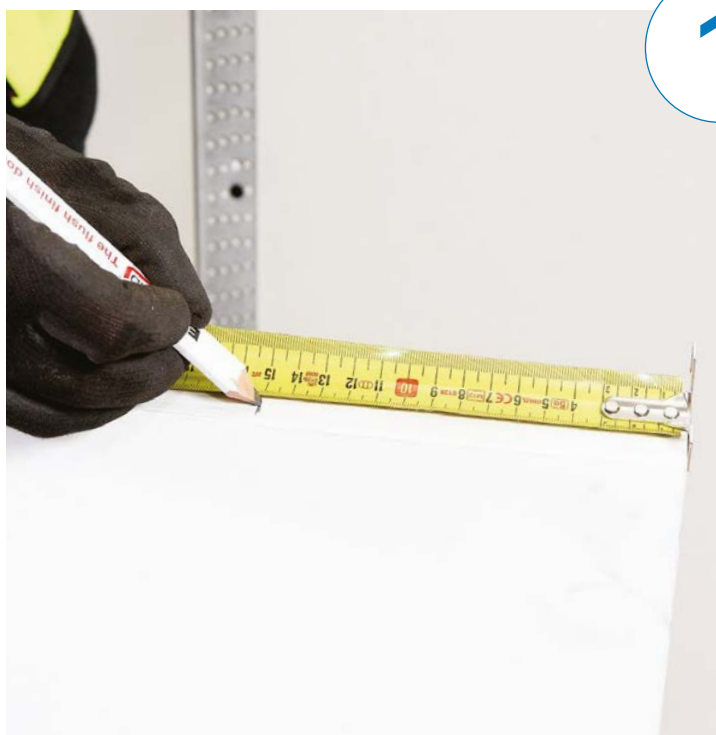

The Selo butt hinges have been specifically designed for the Arriva doorset. They are designed to be surface mounted to the frame and door.

Start off by marking your hinge centres on the door leaf. Measurements can be found on the previous page.

2

Fix hinges



Place the hinge on the door so that the frame leaf is flush with the rear face of the door. Pilot drill and fix through the holes in the smaller leaf of the hinge using the screws provided.

3

Drill holes in frame

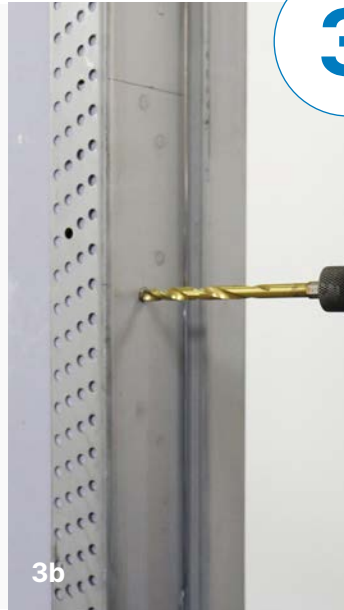

With the hinges fitted to the door, stand the door up and take to the door opening. Accurately mark the position of the top hinge on the frame, making an allowance for a 3mm gap at the top.

3a Line the hinges up to the position marked on the frame. Use a 3mm packer between the hinge and the door stop, mark the 4 hole positions.

3b Using a 6mm metal cutting drill bit, drill four clearance holes in the positions marked.

4

Pack behind frame



Position a nominal 3mm packer behind each pair of clearance holes. Making sure the packers are pushed so that they are up against the inside of the plasterbead.

5

Fix hinges to frame

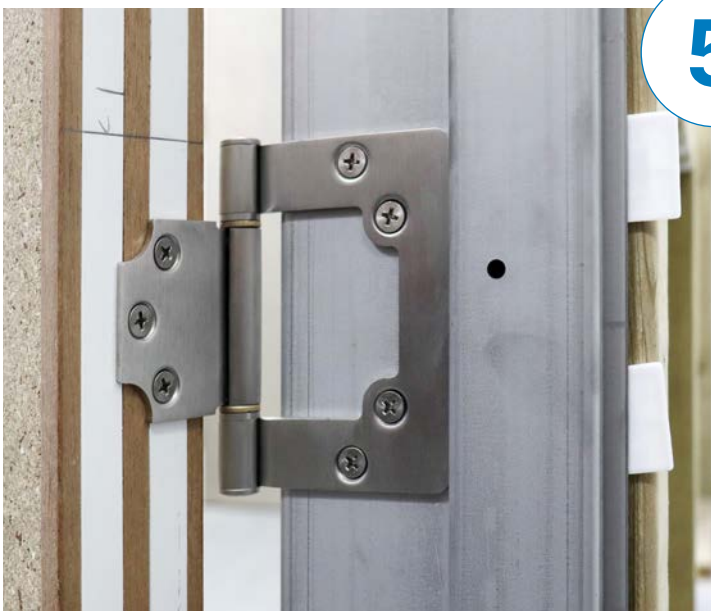

Fix the hinge to the frame with the screws provided making sure the screws pierce the packers.

Fix the all hinges using the fixings provided.



ROC-York hinge Installation guide



1

Notch hinge stud

The hinge stud needs to be notched to accommodate each bracket and hinge.

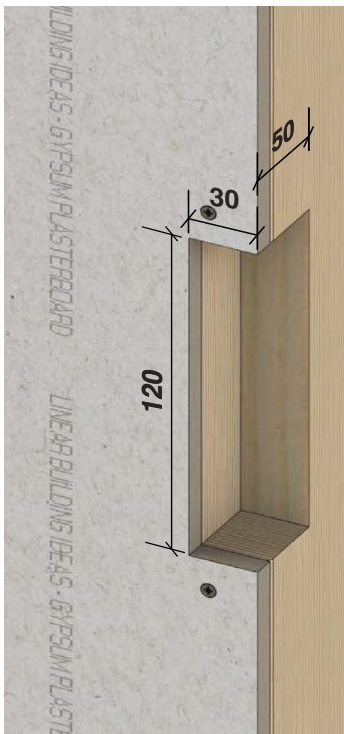

RY-45

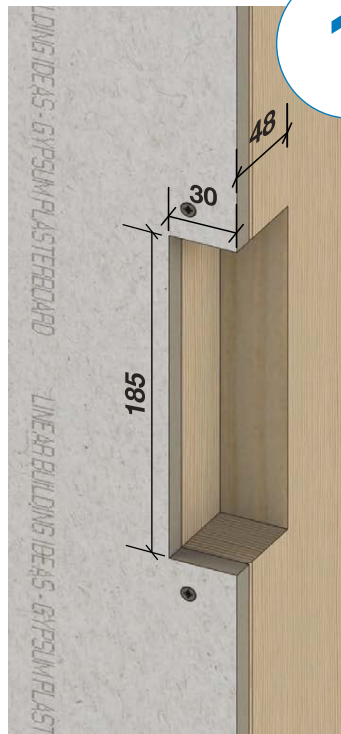

RY-80



1.1 Offer



1.2 Mark

Notch preparation

1.1 Offer the hinge jamb up to the stud and mark a line at the top of the hinge in all the hinge brackets.

1.2 Using template, line the slot in the template up with the lines you have made on the stud and draw around the template.

2

Cut



The recommended tool for cutting the notch is the multi purpose saw. Further details are at the back of the booklet.

3

Identify frame



Arriva frames come pre-morticed for ROC-York hinges. There is a bracket installed on the door frame with pre-threaded holes for simple and secure installation.

4

Fit hinges



Fit the hinges to the door leaf using the screws provided as shown.

5

Fit to frame

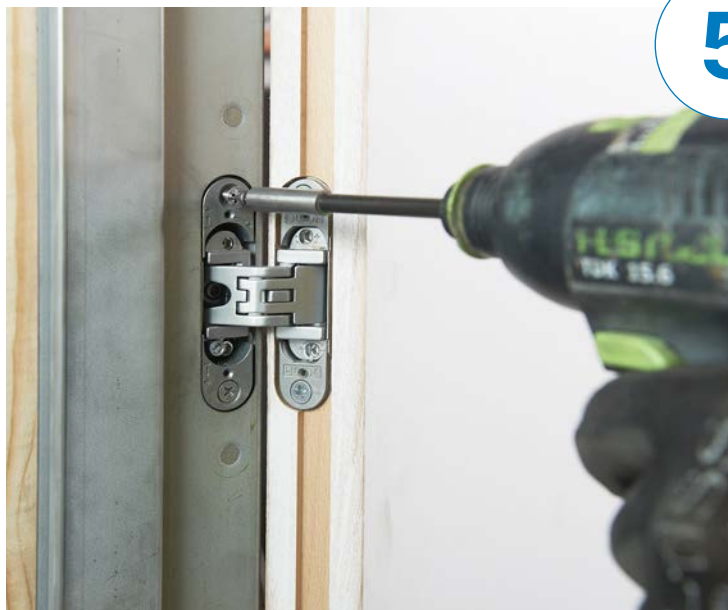

Open out the hinges and with the help of an assistant or a door lifter, offer up and locate the hinges into the mortices in the frame. They are secured using the PH2 bolts provided.

6

Adjustments - Vertical adjustment

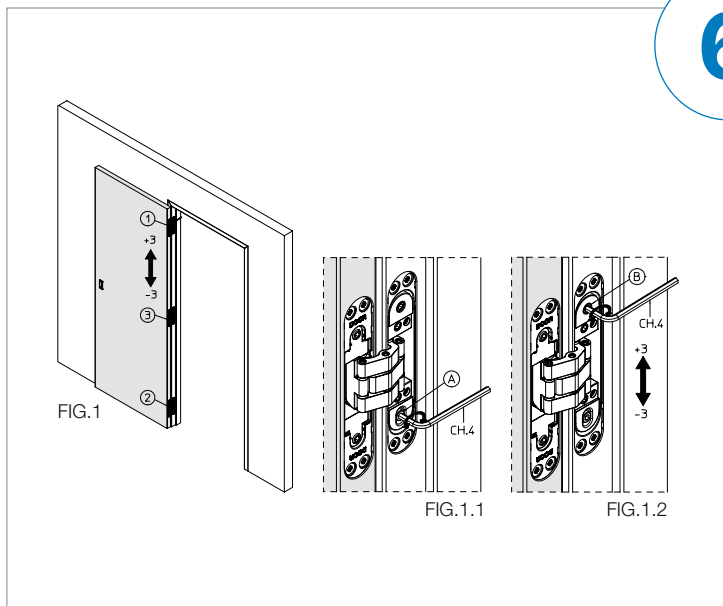

Loosen screw "A" on all hinges (fig.1.1). Proceed with the adjustment of the upper hinge (1). Adjust the hinge by rotating screw "B" (fig.1.2), then tighten the screw "A". Repeat the adjustment on the lower hinge (2) and finally on the central hinge in the middle (3) so that the door leaf weight will be evenly distributed on all hinges.

It is extremely important to obtain a definite adjustment by acting gradually on all mounted hinges.

7

Horizontal adjustment

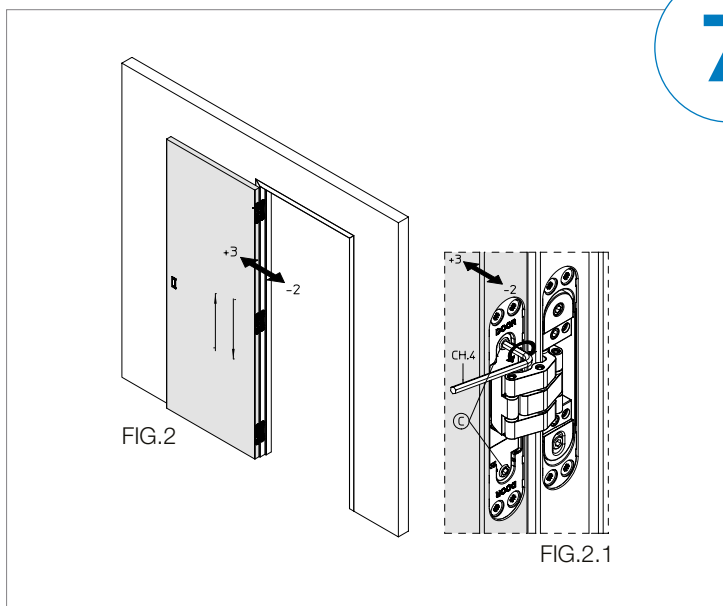

Adjust the door leaf by rotating pins "C" (Wall Construction Preparation. 2.1). Repeat the adjustment on all hinges as shown in the sequence (fig. 2).

8

Depth adjustment

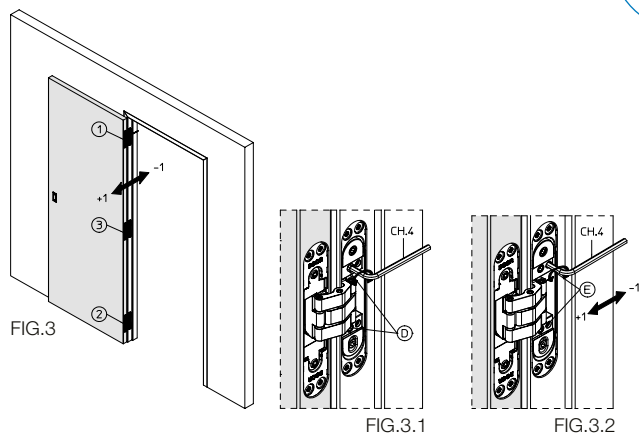

Loosen screw "D" (fig.3.1). Adjust the door leaf by rotating the screws "E" and tighten screw "D" (fig.3.1). Repeat the adjustment on the other hinges as per sequence shown in Fig.3.

After having reached the optimal adjustment with the screw, fix the screw to lock the hinge without forcing.

9

Fit cover plates



Remove the film from the cover plates. Fit the cover plates to the face of the hinge mechanism by carefully clipping into place to finish off the installation.

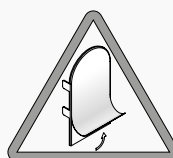

Remove protective film

Self-closer Installation guide

1

Cut-out in frame

Ensure suitable cut-out in stud to accommodate closer frame back-box.

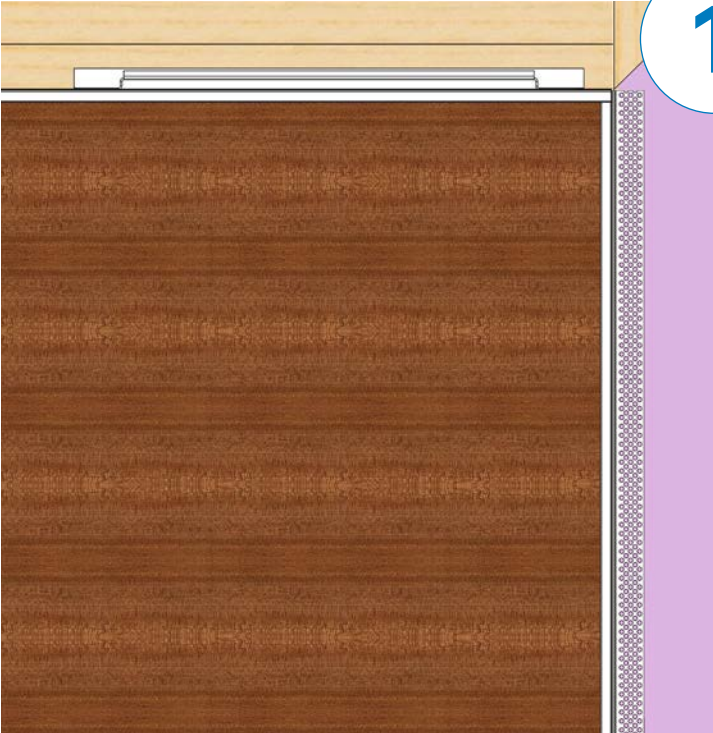

2

Fit rail to frame

Assemble sliding rail and screw into the head frame back box.

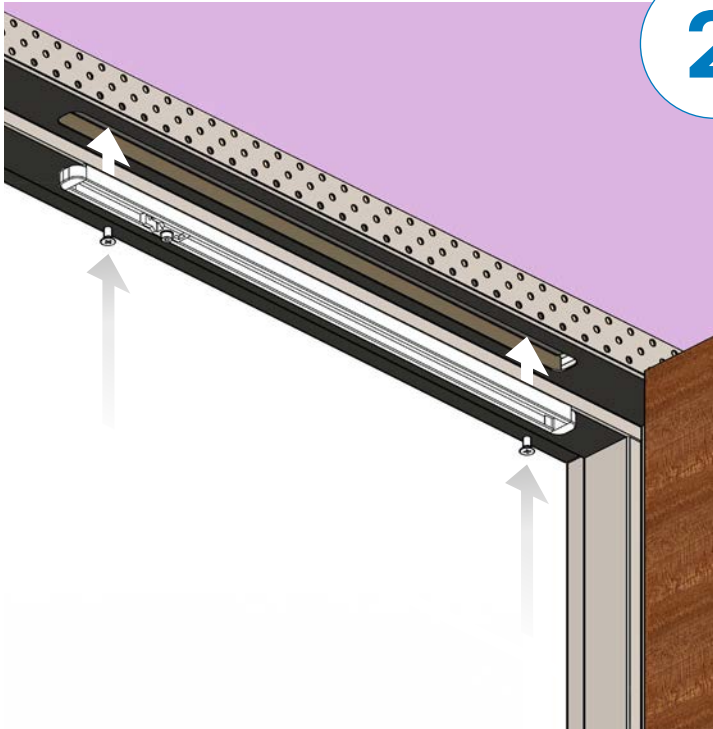

3

Fit closer body to door



Install the closer body into the door.

If fire-rated, ensure to install the intumescent jacket and cover.

4

Attach arm

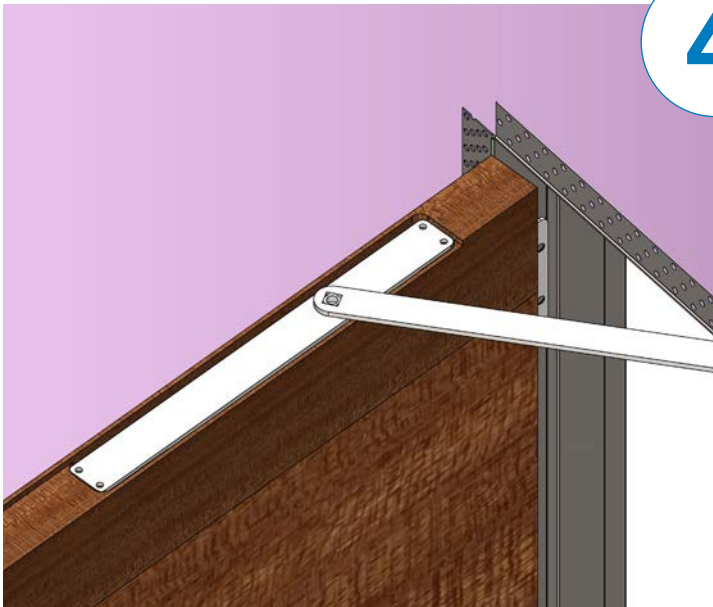

Attach the closer arm between the door and the frame.

5

Adjustments

Refer to manufacturer instructions to adjust the power and speed of the closure.

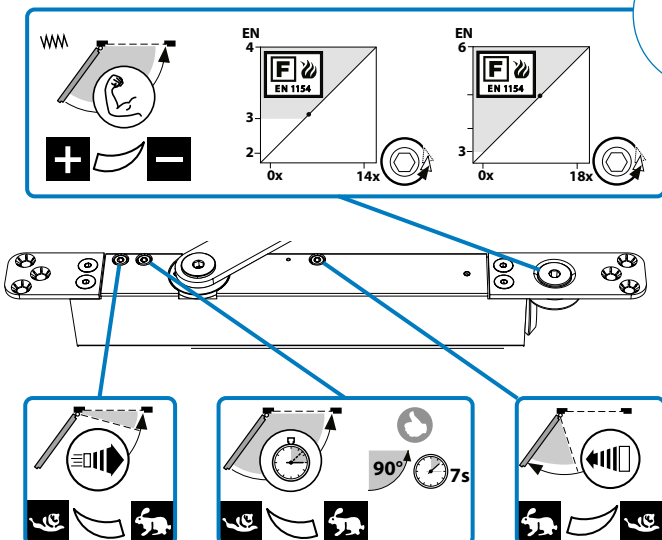



For installation help and advice with your project:
call 020 3880 0339 / **email** sales@selo-uk.com

INSTALLER TRAINING

Hands-on practical installation advice

Complimentary training is provided at our Milton Keynes headquarters. Learn installation tips and tricks directly from the manufacturer; helping improve standards with quality, compliant installations.

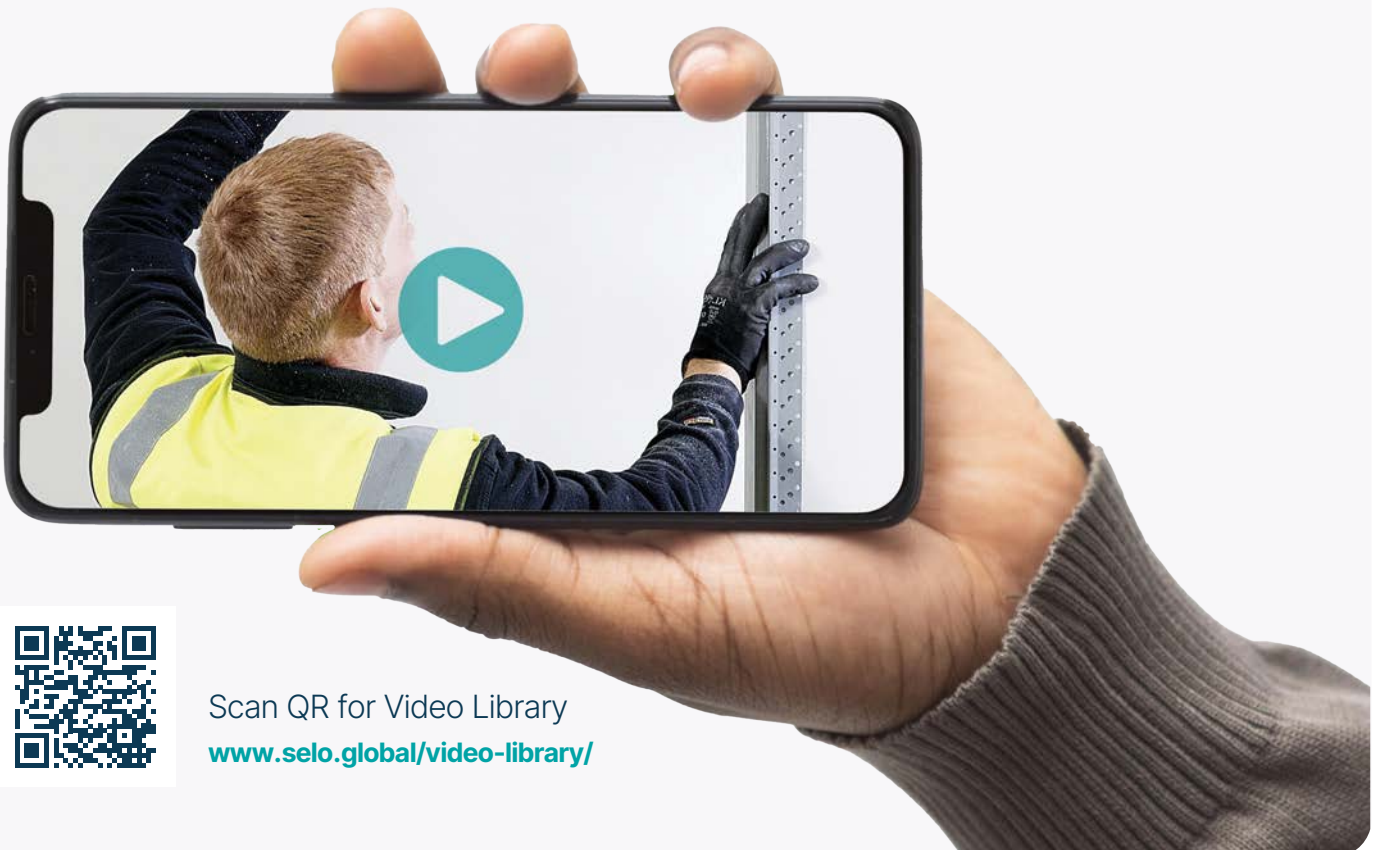

Scan QR for Video Library
www.selo.global/video-library/

Correct storage of Arriva timber doors

For help and advice with the installation of any Selo products, call our dedicated support team on **020 3880 0339**

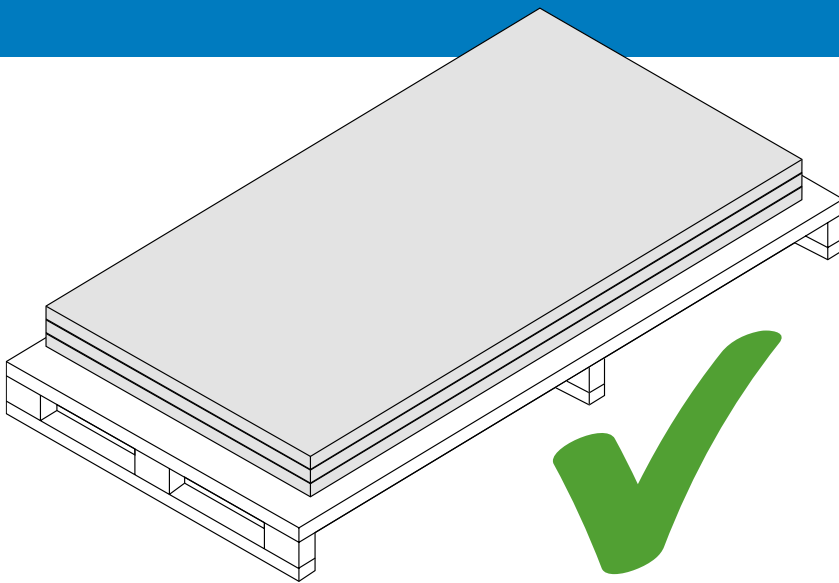

ALWAYS

Lay the doors FLAT with the load spread evenly

Incorrect storage could result in your doors warping, twisting or bowing.

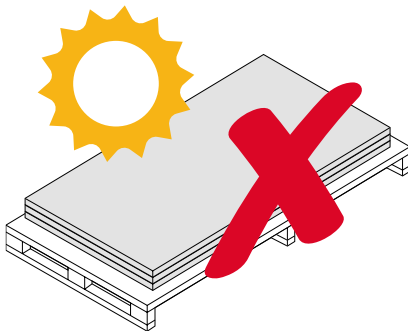

Avoid excessive temperatures

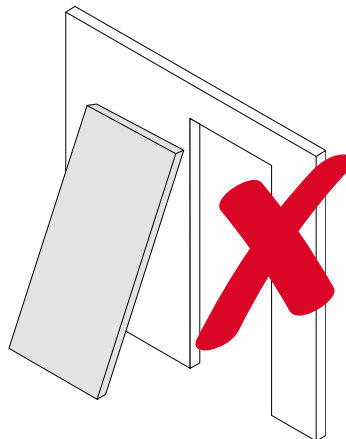

DO NOT leave doors leant against wall

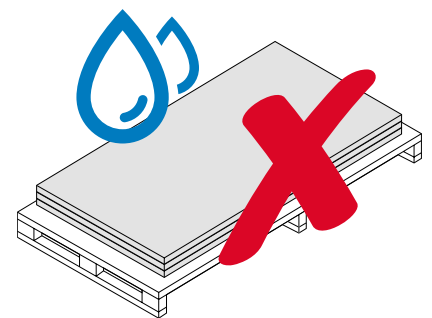

Avoid moisture and damp environments

selo[®]

call 020 3880 0339
email sales@selo-uk.com
www.selo.global

Selo
K2 Kents Hill Business Park Timbold Drive
Milton Keynes MK7 6BZ



Follow us on:

